

REMARKS: *Runways not marked.
Abrupt gradient change last
300' of Rwy 32. Berms
along all Rwy's edges +2'*

NOTE: *Not to Scale
Distances and Heights
are Approximate*

COORDINATES: *40° 24' 48" N (Est.)
116° 52' 28" W (Est.)*

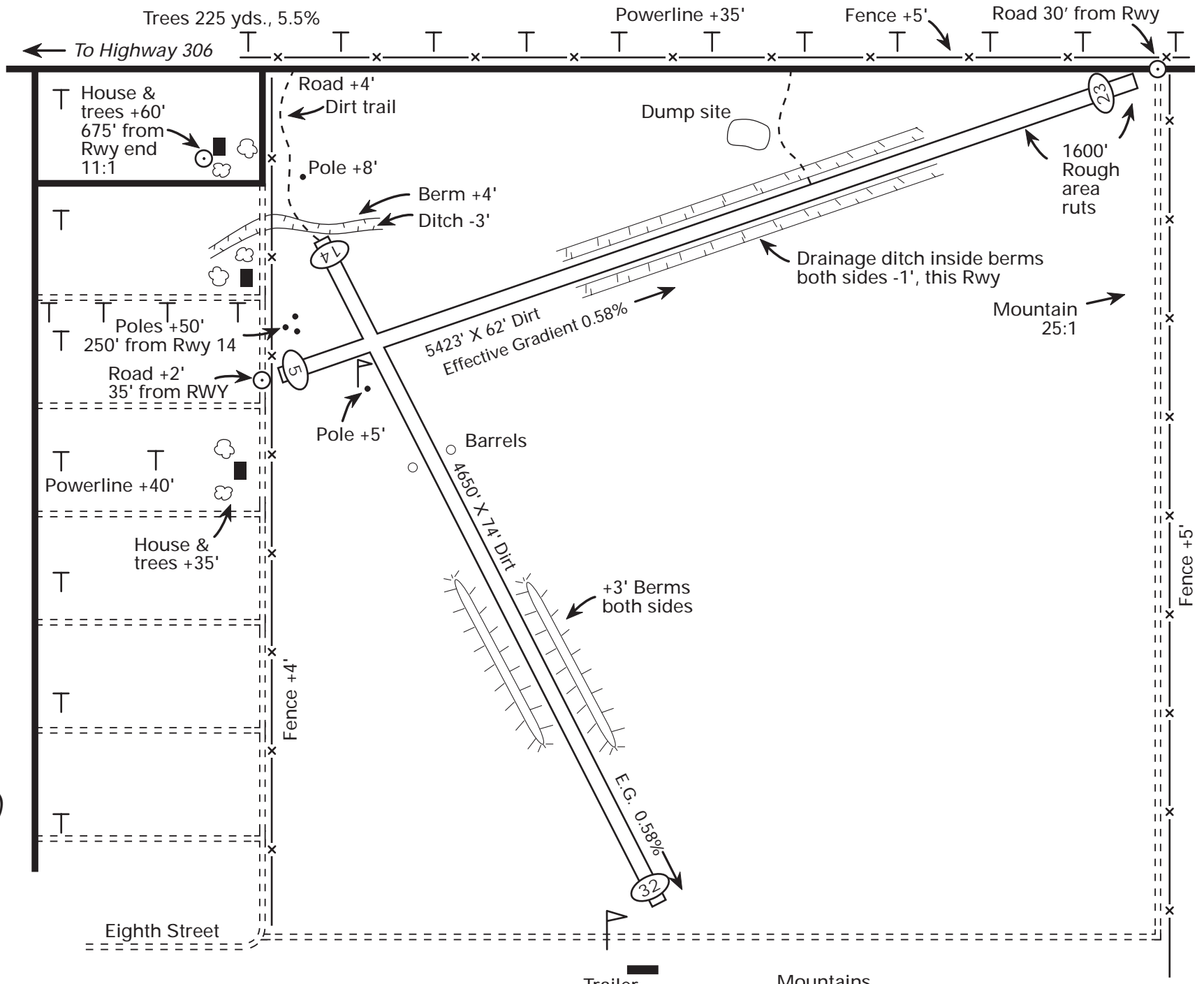

**CRESCENT VALLEY (U74)
CRESCENT VALLEY,
NEVADA**

FOR DETAILED INFORMATION CONTACT
NDOT - PLANNING AVIATION (775) 888-7354

