

SEE ENLARGEMENT

SEE ENLARGEMENT

WADSWORTH-FERNLEY 46

EAST FERNLEY 48

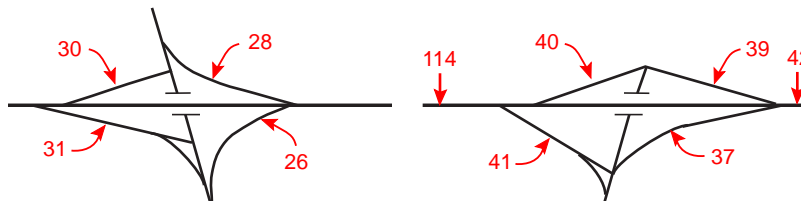

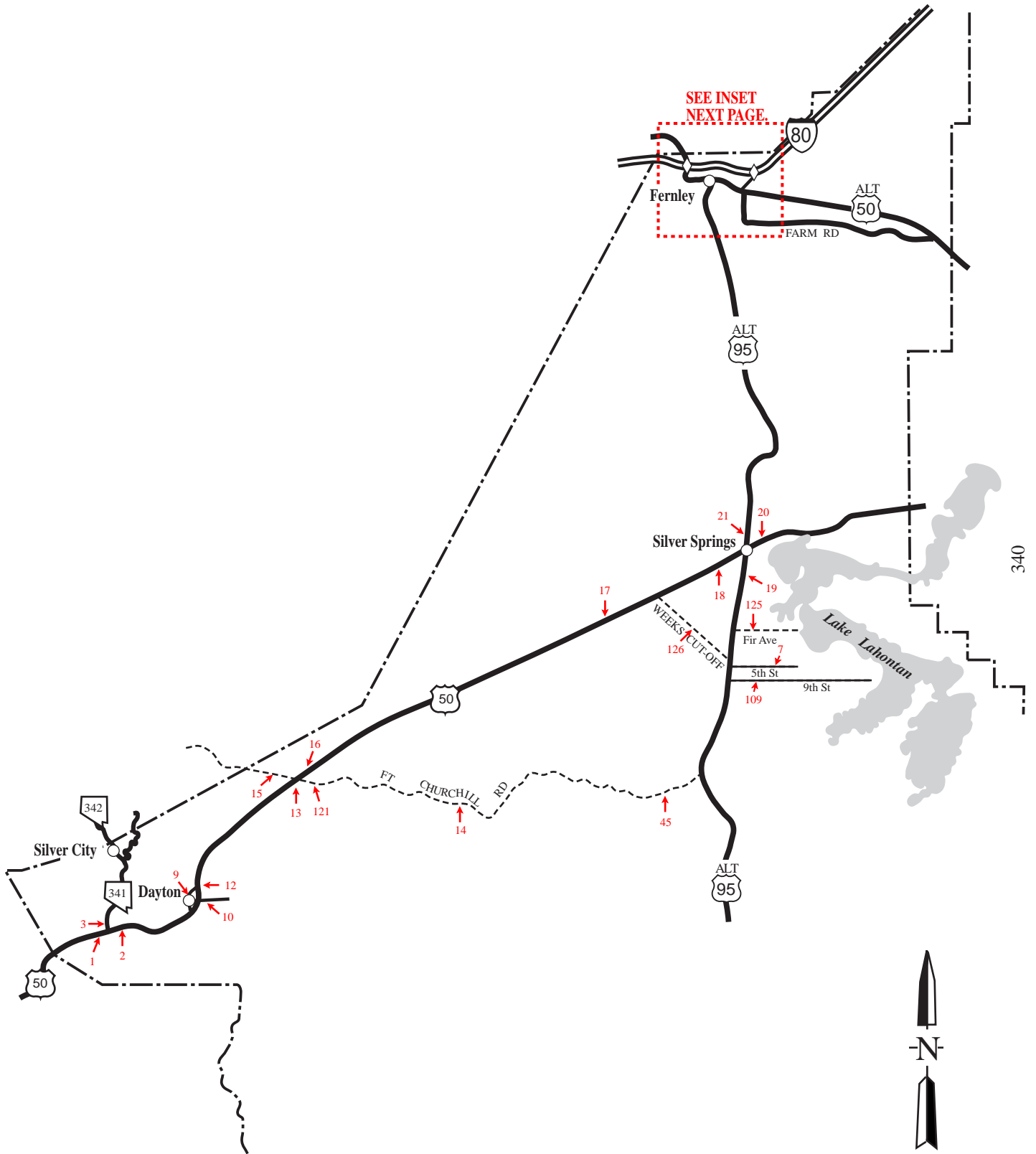

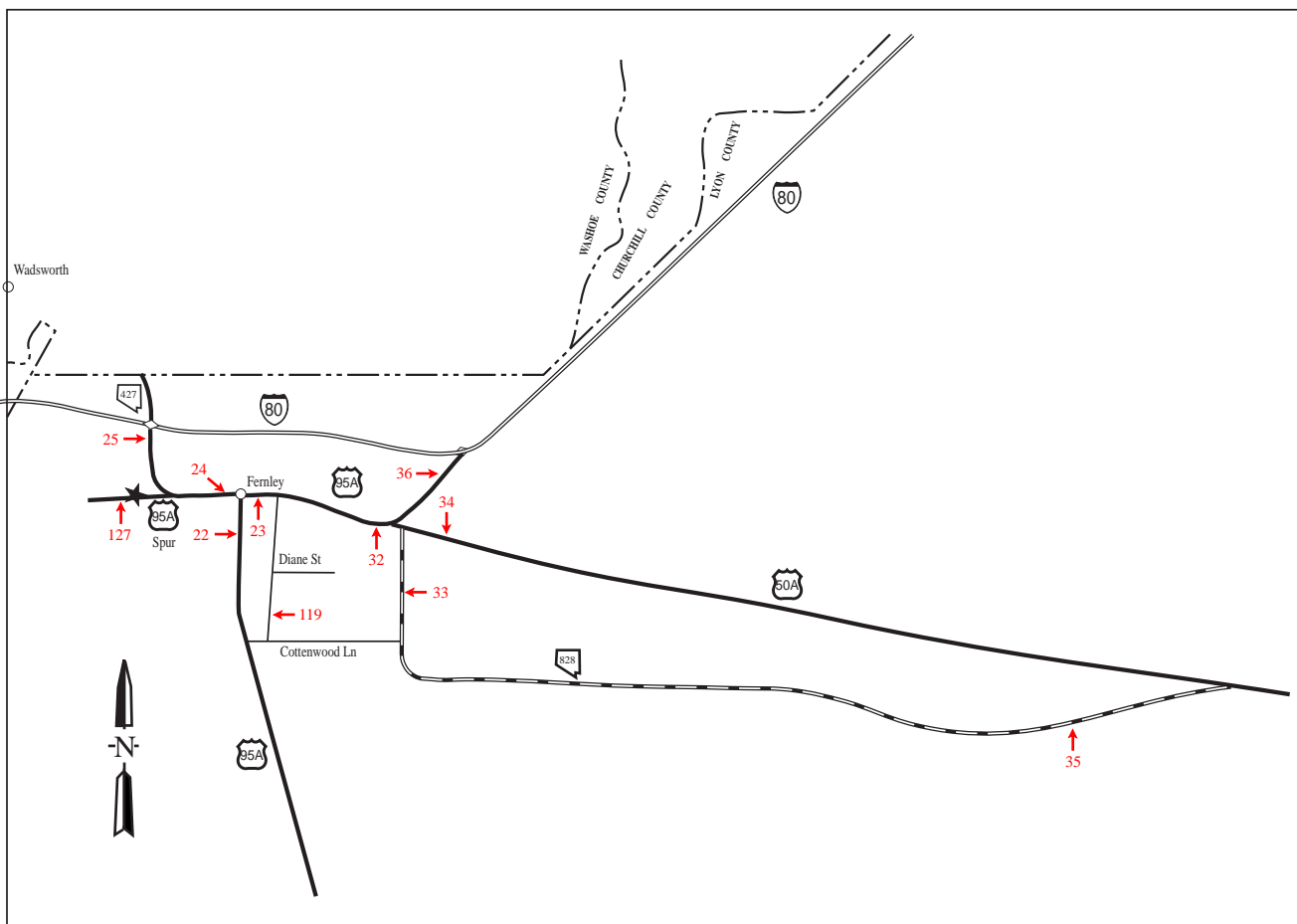

Wadsworth-Fernley
Enlarged Area

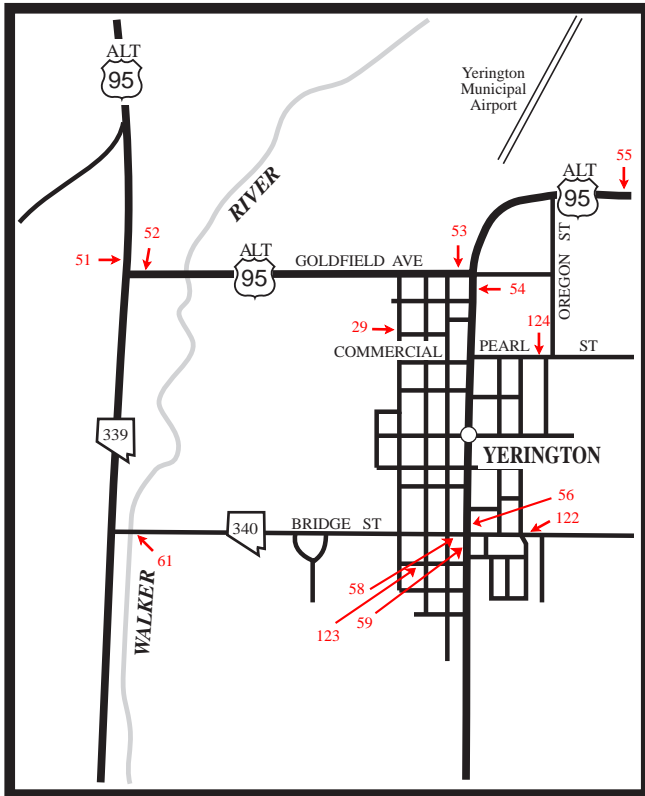

YERINGTON

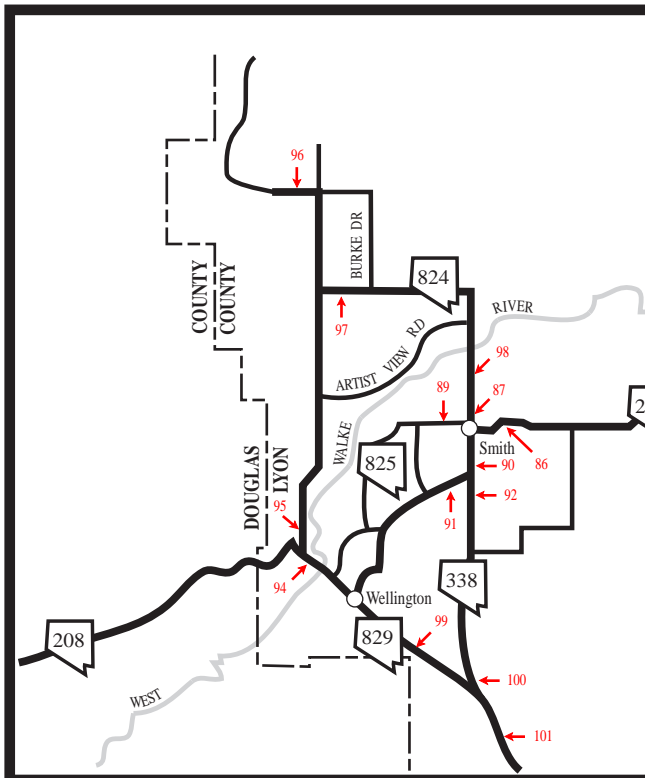
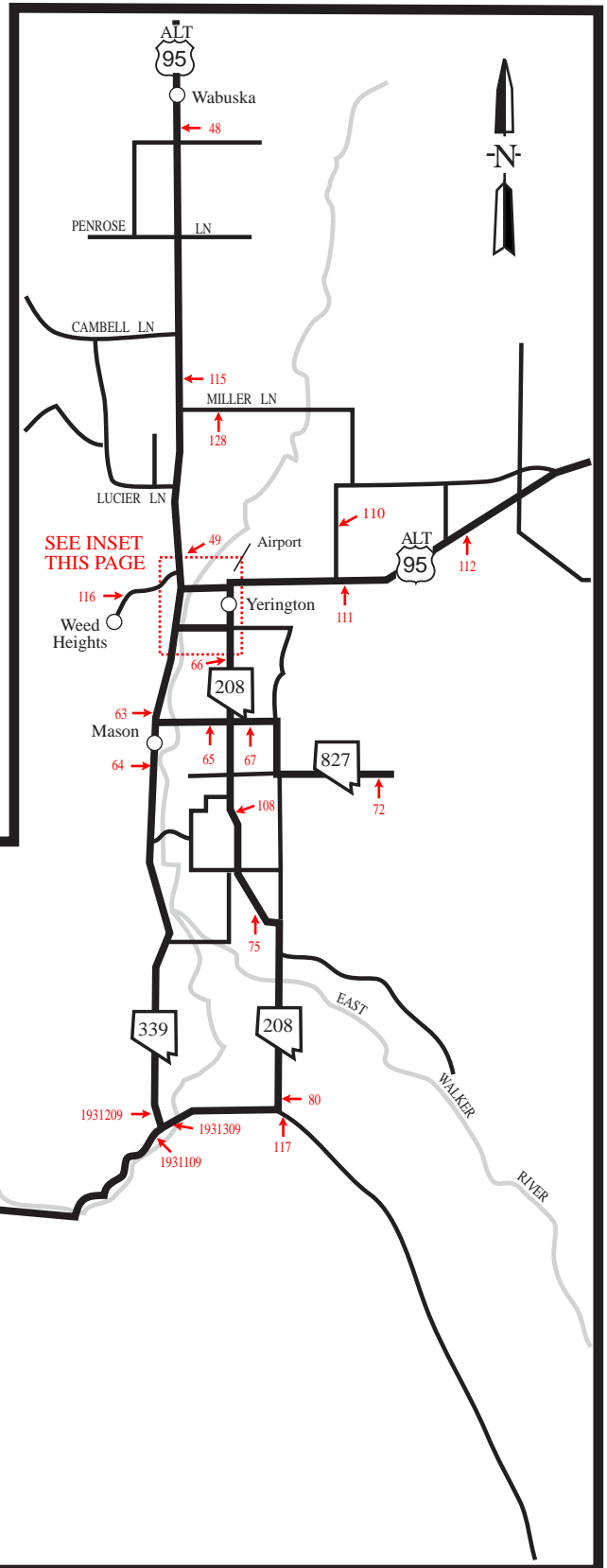

YERINGTON AREA

LYON COUNTY

TABLE 3 - ANNUAL AVERAGE DAILY TRAFFIC AT PORTABLE TRAFFIC COUNT STATIONS -

STATION	1996	1997	1998	1999	2000	2001	2002	2003	2004	2005
0001	US-50, .6 mi W of SR-341 (Virginia City Rd).									
	15000	17100	17100	18500	18200	18600*	21900	25400*	23200	25000
0002	US-50, .2 mi E of SR-341 (Virginia City Rd).									
	14100	14200	14200	15900	15600*	15900*	18600	21600*	19900	22000
0003	SR-341 (Virginia City Rd), 200' N of US-50.									
	2450	2750	2800	3100	2950	2700	2700	3100	3350	3750
0007	Fifth St, .7 mi E of US-95A in Silver Springs at the RxR tracks.									
						510	660	640	710	790
0008	Ninth St, .6 mi E of US-95A in Silver Springs at the RxR tracks.									
							1150	1150	1150*	1300
0009	Pike St, 200' N of Main St in Dayton.									
				590	550	510	600	530	530	520
0010	Dayton Vy Rd, .1 mi E of US-50 in Dayton.									
	6100	6400	6300	6300*	6500	6900	6900*	9100	9500	9500*
0011	Churchill Cy-Thomas Smelter Rd, 2.2 mi W of US-95A N of Wasbuska at US-95A Jct.									
						20	10	20	20*	30
0012	US-50, .2 mi W of the entrance to the Dayton State Park.									
	10700	11600	11600	14400	14400	14400*	16700	17500	20400	20400
0013	US-50, 0.3 mi E of Graves Dr and 0.7 mi W of Occidental Dr. MP LY 10.0									
	8500	8900	8900	10200	10200	9900	12300	12800	13700	15400
0014	County Rd to Fort Churchill, 1.9 mi E of US-50.									
							80	50	50*	130
0015	Six Mile Cy Rd, 1.1 mi W of US-50.									
				1400	1450	1500	1500*	1700*	2250	2600

LYON COUNTY

TABLE 3 - ANNUAL AVERAGE DAILY TRAFFIC AT PORTABLE TRAFFIC COUNT STATIONS -

STATION	1996	1997	1998	1999	2000	2001	2002	2003	2004	2005
0016	US-50, .1 mi E of Chavez Rd. 5550	5400	5400	6050	6000	5600	6400*	6850	7050	7650
0017	US-50, .1 mi E of Cheyenne Rd (in Stage Coach) & 8.2 mi W of US-95A. 3950*	4400*	4800*	5000*	5000*	4900	5500	5600	5800	6250
0018	US-50, .7 mi W of US-95A at Silver Springs. 3170	3400	3700	3850*	3850*	3400	4000	4200	4100	4500
0019	US-95A, .1 miles S of US-50. 5100	5300	5100	5300*	5200	5200	5700	5350	5400*	5900
0020	US-50, 1.5 mi E of US-95A. 1900	1800	2100	2000	2000*	1800	1950	2000*	2050	2200
0021	US-95A, 270' N of US-50. 4200	4150	4300	4600	4500	4900	4900*	5350	5300	5650
0022	US-95A, 320' S of US-95A Spur in Fernley. 5300	5700	6100	6400	6700	6600	7600	8100	9050	9100*
0023	US-95A (Main St), 275' E of US-95A Spur. 8500	9000	9400	9750	10200	10400*	10600*	11200*	12000*	13000*
0024	SR-427 (Main St), 0.3 mi W of US-95A. 9100	9000	9600	10200	10200*	11000	11400	11300*	11900	12900
0025	SR-427 (Main St), 20' S of the RxR underpass btwn Fernley & Wadsworth. 9050	8600	9200	9550	9400	9600*	10900	10800	11000	12000*
0026	IR-80, E/B on-ramp of the Wadsworth-W Fernley Intch 'Exit 46'. 905	880	1225	1160	1100	1000	900	990	1200	1250
0027	East Newlands Dr, .1 mile E of Lyon Dr at the RxR crossing. 1600					1600	1500	1400	1400*	1500

LYON COUNTY

TABLE 3 - ANNUAL AVERAGE DAILY TRAFFIC AT PORTABLE TRAFFIC COUNT STATIONS -

STATION	1996	1997	1998	1999	2000	2001	2002	2003	2004	2005
0028	IR-80, W/B off-ramp of the Wadsworth-W Fernley Intch 'Exit 46'.									
	740	780	1195	1130	1200	1100	900	1000	1450	1400
0029	Whitacre St, .1 mile N of Commercial Av.									
			85	90	90	80	90	90*	80*	
0030	IR-80, W/B on-ramp of the Wadsworth-W Fernley Intch 'Exit 46'									
	2840	2875	3115	2970	3600	3050	3440	3400	3750	4000
0031	IR-80, E/B off-ramp of the Wadsworth-W Fernley Intch 'Exit 46'									
	2885	3095	3170	3170	3780	3400	3650	3650*	4150	4400
0032	US-95A, 200' W of US-50A to Hazen W of the Fernley overpass.									
	8500	9600	10200	10700	11000	11200*	11400*	13300	13900	14500*
0033	SR-828 (Fernley Farm District Rd), .15 mi S of US-50A.									
	2500	2500	3600	3800	4050	4700	5550	5700	6500	6500*
0034	US-50A, 2.6 mi E of SR-828.									
	6350*	7050*	7400*	7450*	7200	7900	8100	8700	10400	10800
0035	SR-828 (Fernley Farm District Rd), .25 mi W of US-50A.									
	270	270	270	340	330	380	510	430	530	660
0036	US-95A, to IR-80 at the N end of guardrail of RxR overpass.									
	12300	13000	13800	15600	15600*	16000	18100	19700	21700	22000*
0037	IR-80, E/B on-ramp of the E Fernley Intch 'Exit 48' .2 mi from cross traffic rd.									
	905	735	725	780	700	640	640	690	620	530
0038	Salvador Dr, E of Lyon Dr at the RxR crossing (Fernley area).									
							390	480	480*	440
0039	IR-80, W/B off-ramp of the E Fernley Intch 'Exit 48'									
	940	770	810	890	790	750	690	790	720	620

LYON COUNTY

TABLE 3 - ANNUAL AVERAGE DAILY TRAFFIC AT PORTABLE TRAFFIC COUNT STATIONS -

STATION	1996	1997	1998	1999	2000	2001	2002	2003	2004	2005
0040	IR-80, W/B on-ramp of the E Fernley Intch 'Exit 48'. 4060	3665	4995	5250	4670	4900	4910	5100	5650	5750
0041	IR-80, E/B off-ramp of the E Fernley Intch 'Exit 48' 3770	3890	4865	4980	4270	4600	4600	4650	5300	5100
0042	IR-80, at milepost LY 8.9. 6085	6685	7380	6950	6950	7090	7410	7800*	8000*	7600*
0045	Fort Churchill Rd, .2 mi W of US-95A. 235	235	235	190	210	230	180	190	190	230
0048	US-95A, .6 mi S of the R/R crossing at Wabuska. 2400	2500	2650	3000	3000	2800	3000*	2970*	2850	2850
0049	US-95A, .5 mi N of the County Rd to Weed Heights. 3800	3900	4100	4400	4400	4300	4500*	4450*	4800	4700*
0051	US-95A, 150' N of US-95A (Goldfield Av). 4700	4800	5100	5400	5300	5100	5450	5600	5600	5500*
0052	US-95A (Goldfield Av), .1 mi E of SR-339. 4350	4600	4700	5000	4800	4800	5050	4900	4900	4800
0053	US-95A (Goldfield Av), 2 Blocks W of SR-208 (Main St). 3800	4000	4000	4250	4250*	4100	4200*	4100*	5450	5450
0054	SR-208 (Main St), 75' S of US-95A (Goldfield Av). 5250	5450	5700	6100	6100*	5800	6300	6000	6150	6600
0055	US-95A, .2 mi E of Oregon St & .6 mi E of SR-208. 3450	3700	3600	3600	3600	3600	3900	3800	3700	4000
0056	SR-208 (Main St), 150' N of SR-340 (Bridge St). 5460	5500	5400	5600	5750	5300	5600	5400	5700	5800

LYON COUNTY

TABLE 3 - ANNUAL AVERAGE DAILY TRAFFIC AT PORTABLE TRAFFIC COUNT STATIONS -

STATION	1996	1997	1998	1999	2000	2001	2002	2003	2004	2005
0058	SR-340 (Bridge St), 4250	.1 mi W of 4150	SR-208 (Main St). 4300	4400	4600*	3900	3900*	3800*	4250	4350
0059	SR-208 (Main St), 3605	.1 mile S of 4100	SR-340 (Bridge St). 4100	4250	4250*	3900	4150	3800	3800*	4400
0061	SR-340 (Bridge St), 3050	.2 mi E of 2950	SR-339. 3050	3000	3150	2700	3000	2900	3050	3350
0063	SR-339 (Nordyke Rd), 2900	.2 mi N of 2800	SR-827 (Mason Rd). 3000	3000	3000	2700	3200	3300	3150	3250
0064	SR-339 (Nordyke Rd), 1550	1 mile S of 1400	SR-827 in Mason. 1550	1600	1530	1500	1750	1950	1850	1950
0065	SR-827 (Mason Rd), 855	400' W of 800	SR-208 (Topaz-Yerington Rd). 800	800	830	770	1050	990	980	930
0066	SR-208 (Topaz-Yerington Rd), 2670	1.4 mi N of 2600	SR-827 (Mason Rd). 2650	2600	2600	2400	2750	2900	2850	3000
0067	SR-827 (Cremetti Ln), 195	.25 mi E of 195	SR-208. 195	300	280	240	240*	340	360	380
0072	Pursel Ln, 2.3 mi E of 40	SR-827 (McKenzie Ln). 45	45	40	40	40	40*	30	30*	40
0075	SR-208 (Topaz-Yerington Rd), 435	.6 mi N of MacKenzie Ln & 450	.1 mi S of Fridhoff Ln. 475	570	510	470	610	600	580	570
0080	SR-208 (Topaz-Yerington Rd), 400	100' N of Pine Grove Rd. 410	420	470	450	410	540	510	520	500
0086	SR-208 (Topaz-Yerington Rd), 1450	.3 mi E of leg of Wye to 1550	SR-824 in Smith. 1650	1600	1650	1600	1750	1850	1950	1850

LYON COUNTY

TABLE 3 - ANNUAL AVERAGE DAILY TRAFFIC AT PORTABLE TRAFFIC COUNT STATIONS -

STATION	1996	1997	1998	1999	2000	2001	2002	2003	2004	2005
0087	SR-824 (Day Lane), 155' N of E leg of Wye to SR-208 & 293' S of SR-825. 1080	1080	970	1050	980	840	1000	1050	1100	1050
0089	SR-825 (Gage Rd), in Smith .1 mi W of SR-824 (Day Ln). 180	220	220	175	170	160	180	160	180	170
0090	SR-208 (Topaz-Yerington Rd), .2 mi N of SR-338 S of Smith. 1600	1550	1400*	1475	1400	1400	1650	1650	1850	1700
0091	SR-208 (Topaz-Yerington Rd), .2 mi W of SR-338 S of Smith. 1400	1300	1350	1200	1200*	1200	1350	1350	1450	1350
0092	SR-338 (Sweetwater Rd), .1 mi S of SR-208 S of Smith. 445	445	410	400	390	420	420	460	460	440
0094	SR-208 (Topaz-Yerington Rd), .5 mi E of SR-823 to Colony District. 1950	1800	1850	1900	1500	1500	2050	2000	2100	2000
0095	SR-823 (Colony District Rd), Lower Colony Rd .2 mi N of SR-208. 675	665	680	700	600*	590	720	760	790	840
0096	SR-823 (Artesia Rd), .1 mi W of jct of SR-823 (Hunewell Ln) N of SR-824. 180	190	170	290	200	160	220	200	210	210
0097	SR-824 (Day Ln), .2 mi E of SR-823 (Colony District Rd). 290	265	240	380	320	260	260*	320	360	330
0098	SR-824 (Day Ln), 1.5 mi N of SR-825 (Gage Rd) in Smith. 760	760	690	820	760*	760	790	790	850	800
0099	SR-829 (Wellington Rd), 1.2 mi E of SR-208 (Topaz-Yerington Rd) S of Wellington. 385	385	380	360	280*	260	410	380	420	380
0100	SR-338 (Sweetwater Rd), .1 mi N of SR-829 (Wellington Rd). 285	285	225	260	230	240	340	310	340	260

LYON COUNTY

TABLE 3 - ANNUAL AVERAGE DAILY TRAFFIC AT PORTABLE TRAFFIC COUNT STATIONS -

STATION	1996	1997	1998	1999	2000	2001	2002	2003	2004	2005	
0101	SR-338 (Sweetwater Rd), 425	.15 mi S of 425	SR-829 (Wellington Rd). 420	420	400	390	550*	500	560	540	
0103	SR-338 (Sweetwater Rd), 285	3.9 mi S of 285	the County Rd at mp 9.7. 280	275	260*	260*	310	290	310	290	
0108	SR-208 (Topaz-Yerington Rd), 1240	300' S of 1280	SR-827 (Mason Rd). 1350	1350	1250	1200	1390*	1500	1400	1450	
0109	Ninth St, .2 mi E of US-95A.						1300	1200	1250	1300	
0110	County Rd (Old US-95A), to Mason Vy Wildlife Mgt Area .2 mi N of US-95A.				250	200	190	360	310	370	370*
0111	US-95A, .45 mi E of Pete Hendricks Rd. 2300	2250	2500	2500	2300	2600	2450	2650	2600	2650	
0112	US-95A, .1 mi E of Miley Rd & .1 mi E of mp 7. 1600	1650	1650	1650	1600	1800	1850	1900	1850	1800	
0114	IR-80, at mp LY 2.66 12070	12735	15705	15510	14400	15200*	15590	15900	18000*	17000*	
0115	US-95A, btwn Miller Ln & Campbell Ln. 3350	3400	3500	3650	3500	3600	3900	3850	3800*	3700*	
0116	Weed Heights Rd, .5 mi W of US-95A. 1050	1100	1000	900	930	930*	860	900	800*	660	
0117	Pine Grove (Bodie Rd), .2 mi S of SR-208. 70	70	70	70	50	80	110	60	60*	70	
0118	Gallagher Pass Rd (Campbell Ln), 5.1 mi W of US-95A. 40*	40*	40*	40*	30	30	10	50	50*	50	

LYON COUNTY

TABLE 3 - ANNUAL AVERAGE DAILY TRAFFIC AT PORTABLE TRAFFIC COUNT STATIONS -

STATION	1996	1997	1998	1999	2000	2001	2002	2003	2004	2005
0119	Hardy Ln, .3 mi N of Cottonwood Ln.									
	980	865	840	850	1300	1300*	1400	1100	1300	1450
0121	Fort Churchill Rd, .15 mi S of US-50 E of Dayton.									
	110	110	100	110	120	140	140*	140*	160*	230
0122	Bridge St, .1 mi E of Charlotte Av in Yerington.									
	710	710	720	770	700	680	600	600*	720	720
0123	Orchard St, E of Whitaker Av in Yerington.									
			40	40	40	40	40	50	50*	40
0124	Pearl St, 117' W of Oregon St in Yerington.									
			1000	1000*	1100	1250	1250*	1300*	1600	
0125	Fir St, in Silver Springs E of US-95A.									
			830	800	920	940	850	980	960	
0126	Weeks-Ramsey Cutoff Rd, .1 mi S of US-50.									
			1800	1750	1800	1800*	1900	2300	2200	
0127	Truckee Ln, .1 miles W of US-95A Spur in Fernley.									
			820	700	810	820	820*	780	800	
0128	Miller Ln, .1 mi E of US-95A.									
							620	640	570	630

LYON COUNTY

TABLE 3 - ANNUAL AVERAGE DAILY TRAFFIC AT PORTABLE TRAFFIC COUNT STATIONS -

STATION	1996	1997	1998	1999	2000	2001	2002	2003	2004	2005
1931109	SR-208 (Topaz-Yerington Rd), 200' W of SR-339 (Norddyke Rd). 1330	1355	1335	1320	1325	1325	1430	1435	1500	1500
1931209	SR-339 (Norddyke Rd), 200' N of SR-208 (Yerington Rd). 1115	1035	1100	1085	1080	1120	1125	1155	1208	1250
1931309	SR-208 (Topaz-Yerington Rd), 200' E of SR-339 (Norddyke Rd). 330	360	365	360	370	390	435	405	433	410