

WADSWORTH-FERNLEY 46

EAST FERNLEY 48

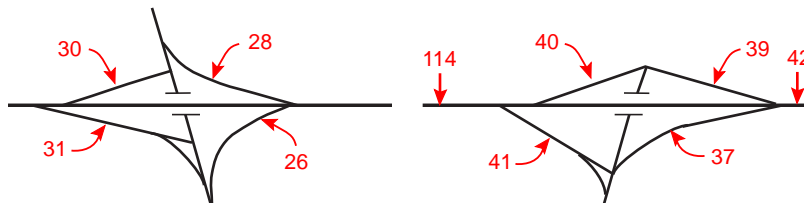

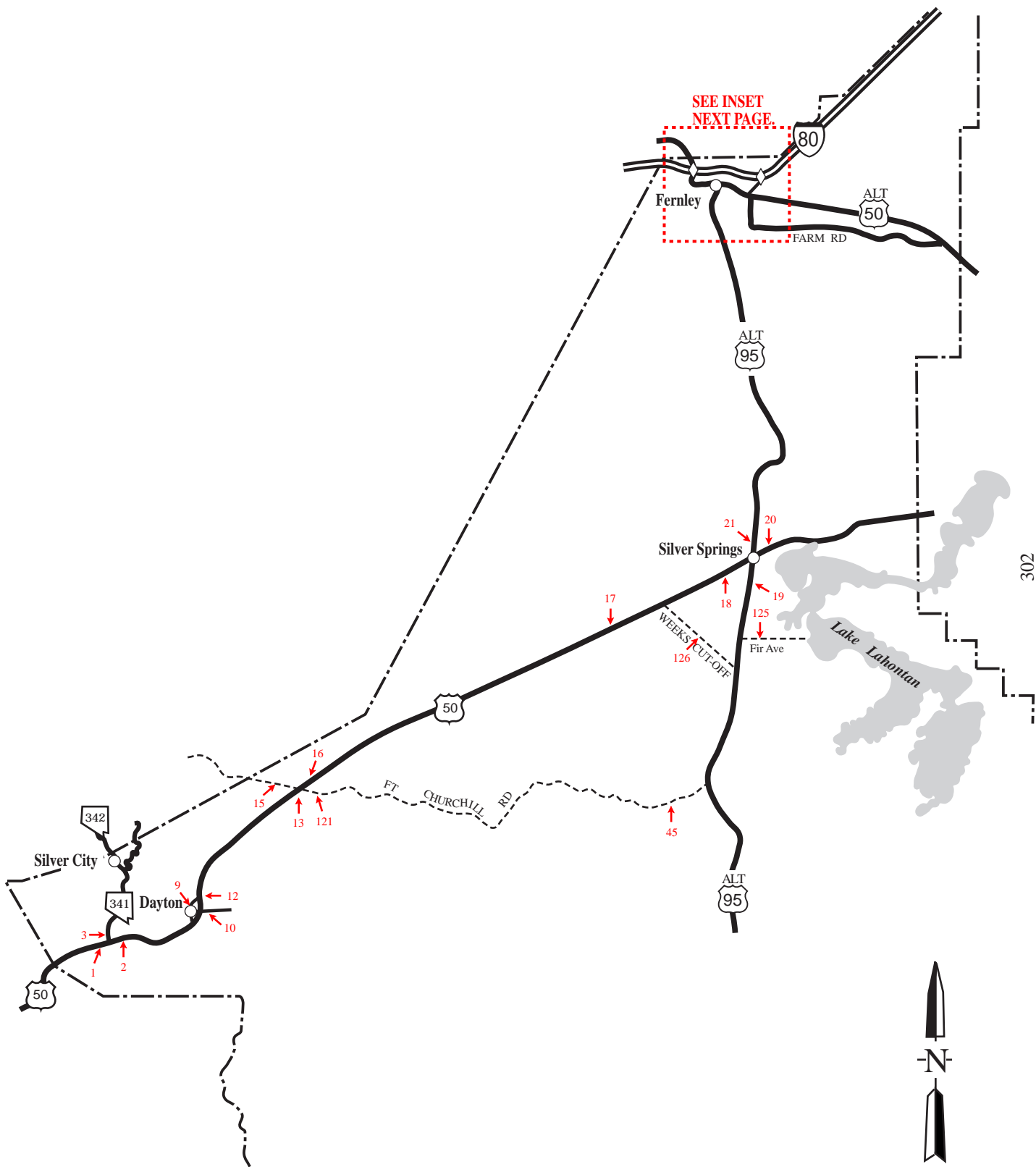

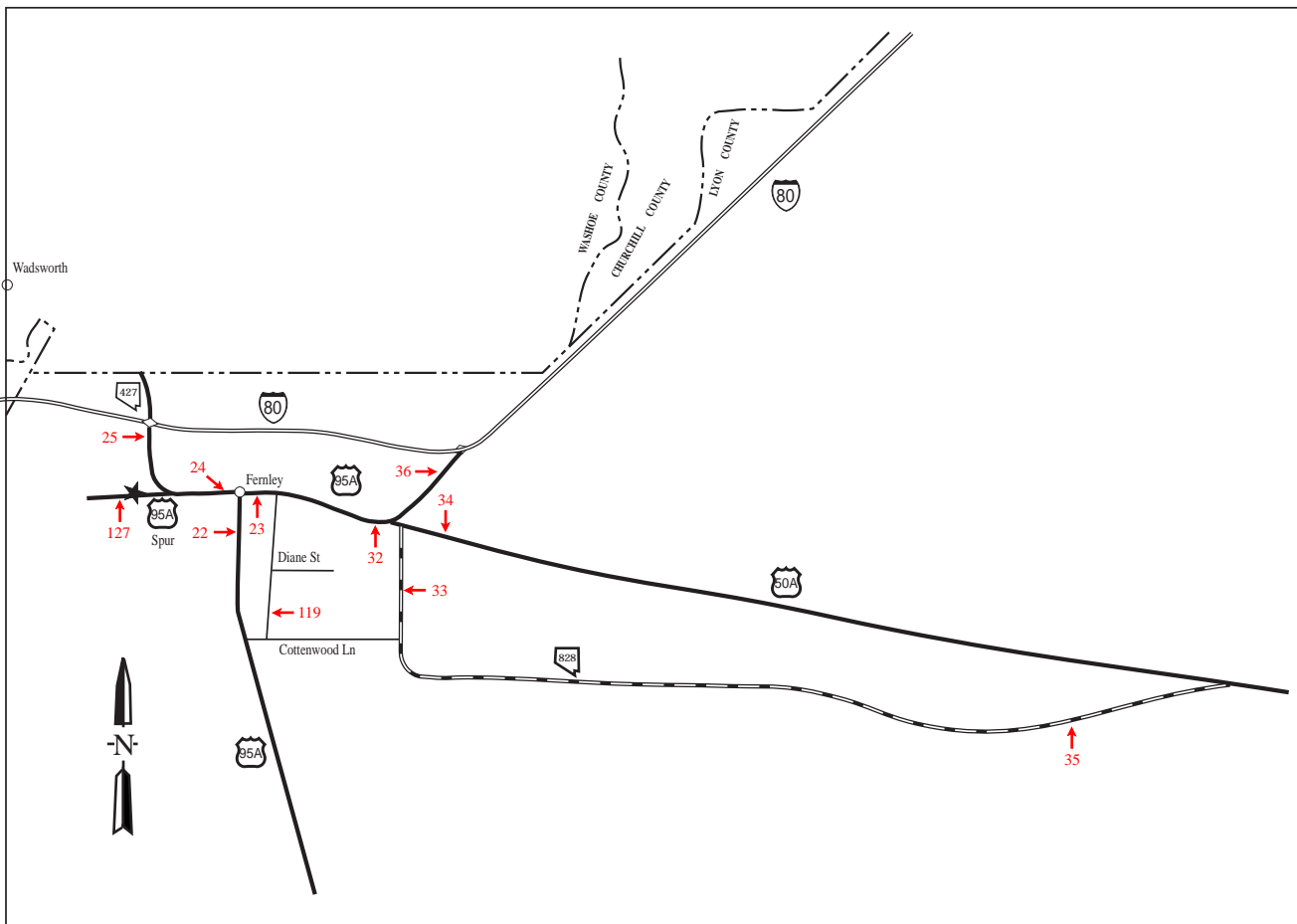

Wadsworth-Fernley
Enlarged Area

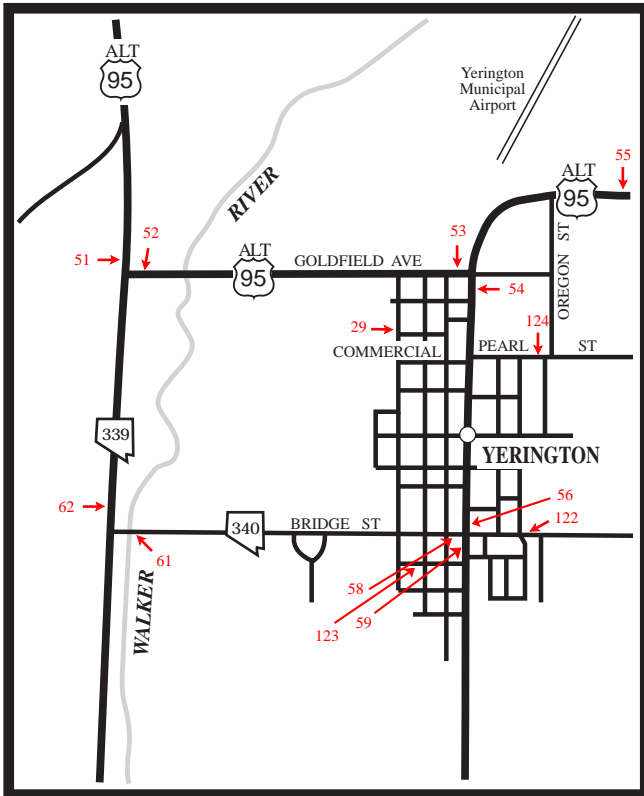

YERINGTON

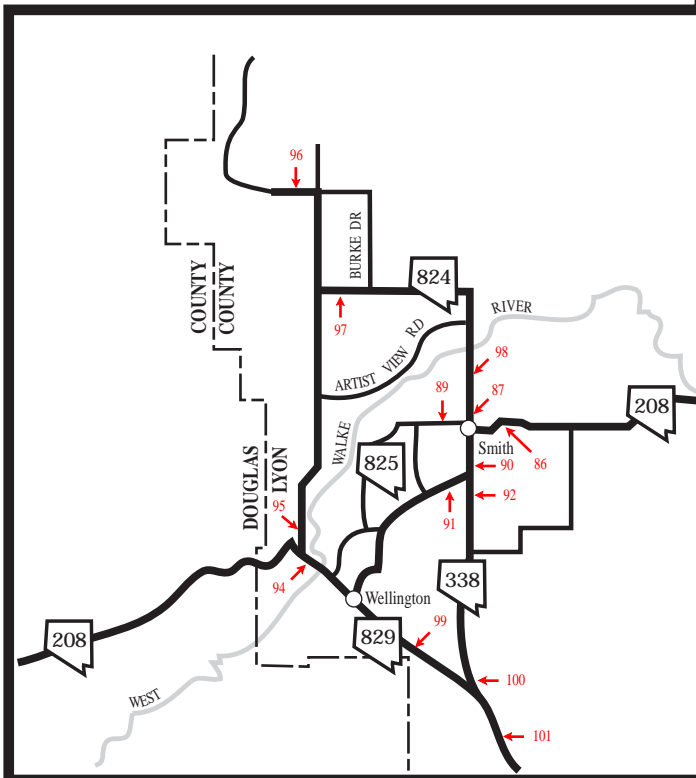
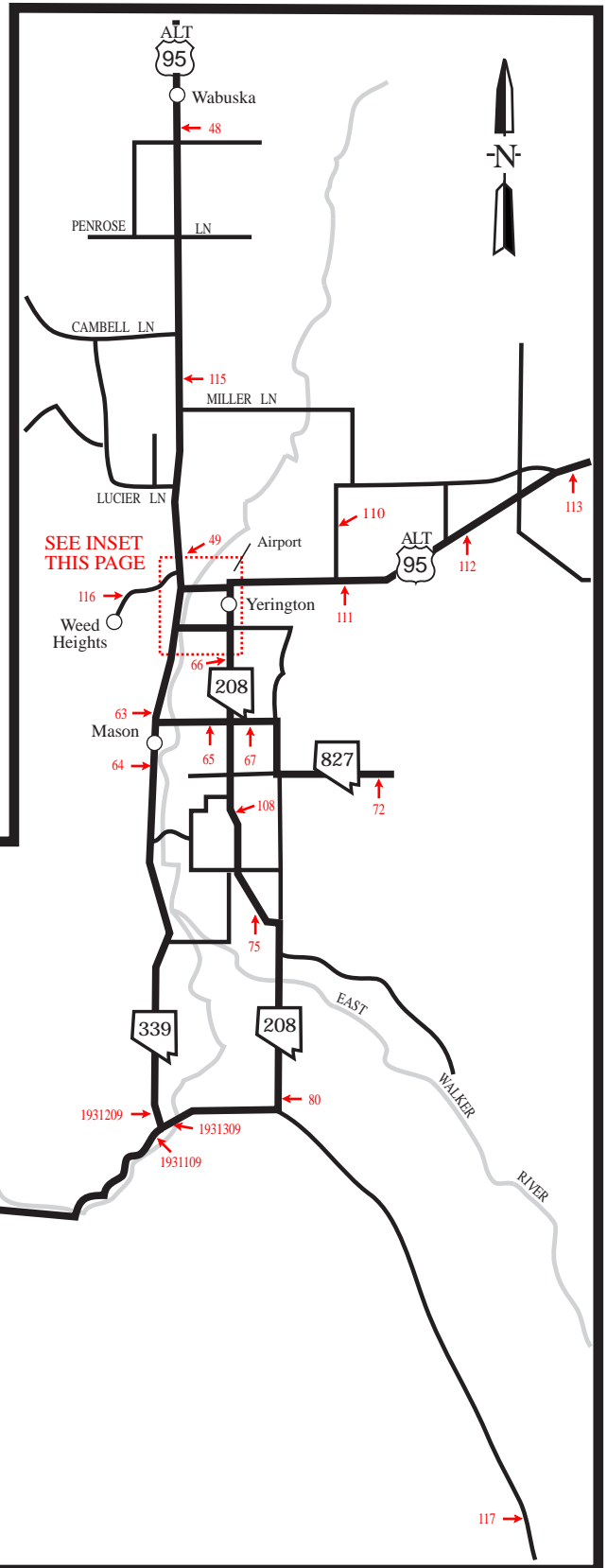

YERINGTON AREA

LYON COUNTY

TABLE 3 - ANNUAL AVERAGE DAILY TRAFFIC AT PORTABLE TRAFFIC COUNT STATIONS -

STATION	1994	1995	1996	1997	1998	1999	2000	2001	2002	2003	
0001 HRLY 02	US-50, .6 mi W of SR-341 (Virginia City Rd).										
	16800	15700	15000	17100	17100	18500	18200	18600*	21900*	25400*	
0002 HRLY 02	US-50, .2 mi E of SR-341 (Virginia City Rd).										
	14500	14800	14100	14200	14200	15900	15600*	15900*	18600*	21600*	
0003 HRLY 03	SR-341 (Virginia City Rd), 200' N of US-50.										
	3045	3115	2450	2750	2800	3100	2950	2700	2700	3100	
0009 HRLY 03	Pike St, 200' N of Main St in Dayton.										
						590	550	510	600	530	
0010 HRLY 03	Dayton Vy Rd, .1 mi E of US-50 in Dayton.										
	5485	6220	6100	6400	6300	6300*	6500	6900	6900	9100	
0012 HRLY 03	US-50, .2 mi W of the entrance to the Dayton State Park.										
	8790	9840	10700	11600	11600	14400	14400	14400	16700	17500	
0013 HRLY 03	US-50, at mp US-50-LY-10.										
	7510	8350	8500	8900	8900	10200	10200	9900	12300	12800	
0014 HRLY 03	County Rd to Fort Churchill, 1.9 mi E of US-50.										
									80	50	
0015 HRLY 01	Six Mile Cy Rd, 1.1 mi W of US-50.										
						1400	1450	1500*	1500*	1700*	
0016 HRLY 03	US-50, .1 mi E of Chavez Rd.										
	4610	4950	5550	5400	5400	6050	6000	5600	6400	6850	
0017 HRLY 03	US-50, .1 mi E of Cheyenne Rd (in Stage Coach) & 8.2 mi W of US-95A.										
	3600*	3950*	3950*	4400*	4800*	5000*	5000*	4900	5500	5600	
0018 HRLY 03	US-50, .7 mi W of US-95A at Silver Springs.										
	3180	3170	3170	3400	3700	3850*	3850*	3400	4000	4200	

LYON COUNTY

TABLE 3 - ANNUAL AVERAGE DAILY TRAFFIC AT PORTABLE TRAFFIC COUNT STATIONS -

STATION	1994	1995	1996	1997	1998	1999	2000	2001	2002	2003
0019 HRLY 03	US-95A, .1 miles S of US-50.		5100	5300	5100	5300*	5200	5200	5700	5350
0020 HRLY 02	US-50, 1.5 mi E of US-95A.		1900	1800	2100	2000	2000*	1800*	1950*	2000*
0021 HRLY 03	US-95A, 270' N of US-50.		4200	4150	4300	4600	4500	4900	4900	5350
0022 HRLY 03	US-95A, 320' S of US-95A Spur in Fernley.		5300	5700	6100	6400	6700	6600	7600	8100
0023 HRLY 00	US-95A (Main St), 275' E of US-95A Spur.		8500	9000	9400	9750	10200	10400*	10600*	11200*
0024 HRLY 02	US-95A Spur, 100' W of US-95A.		9100	9000	9600	10200	10200*	11000*	11400*	11300*
0025 HRLY 03	US-95A Spur, 20' S of the RxB underpass btwn Fernley & Wadsworth.		9050	8600	9200	9550	9400	9600	10900	10800
0026 HRLY 04	IR-80, E/B on-ramp of the Wadsworth-W Fernley Intch 'Exit 46'.		905	880	1225	1160	1100	1000	900	990
0028 HRLY 04	IR-80, W/B off-ramp of the Wadsworth-W Fernley Intch 'Exit 46'.		740	780	1195	1130	1200	1100	900	1000
0029 HRLY 03	Whitacre St, .1 mile N of Commercial Av.					85	90	90	80	90
0030 HRLY 04	IR-80, W/B on-ramp of the Wadsworth-W Fernley Intch 'Exit 46' 375' W of SR-427.		2840	2875	3115	2970	3600	3050	3440	3400
0031 HRLY 04	IR-80, E/B off-ramp of the Wadsworth-W Fernley Intch 'Exit 46' 340' W of US-95A Spur.		2885	3095	3170	3170	3780	3400*	3650*	3650*

LYON COUNTY

TABLE 3 - ANNUAL AVERAGE DAILY TRAFFIC AT PORTABLE TRAFFIC COUNT STATIONS -

STATION	1994	1995	1996	1997	1998	1999	2000	2001	2002	2003
0032 HRLY 03	US-95A, 200' W of US-50A to Hazen W of the Fernley overpass.									
	8540	8560	8500	9600	10200	10700	11000	11200	11400	13300
0033 HRLY 03	SR-828 (Fernley Farm District Rd), .2 mi S of US-50A.									
	2435	2490	2500	2500	3600	3800	4050	4700	5550	5700
0034 HRLY 03	US-50A, 2.6 mi E of SR-828.									
	5750*	5650*	6350*	7050*	7400*	7450*	7200	7900	8100	8700
0035 HRLY 03	SR-828 (Fernley Farm District Rd), .25 mi W of US-50A.									
	250	210	270	270	270	340	330	380	510	430
0036 HRLY 03	US-95A, to IR-80 at the N end of guardrail of RxB overpass.									
	11200	10800	12300	13000	13800	15600	15600*	16000	18100	19700
0037 HRLY 04	IR-80, E/B on-ramp of the E Fernley Intch 'Exit 48' .2 mi from cross traffic rd.									
	960	845	905	735	725	780	700	640	640	690
0039 HRLY 04	IR-80, W/B off-ramp of the E Fernley Intch 'Exit 48' 100' NE of the cross traffic rd.									
	920	835	940	770	810	890	790	750	690	790
0040 HRLY 04	IR-80, W/B on-ramp of the E Fernley Intch 'Exit 48'.									
	3665	3800	4060	3665	4995	5250	4670	4900	4910	5100
0041 HRLY 04	IR-80, E/B off-ramp of the E Fernley Intch 'Exit 48' .1 mi from W end of ramp.									
	3855	3665	3770	3890	4865	4980	4270	4600	4600	4650
0042 HRLY 04	IR-80, at milepost LY 8.9.									
	6350	6685	6085	6685	7380	6950	6950	7090*	7410*	7800*
0045 HRLY 03	Fort Churchill Rd, .2 mi W of US-95A.									
				235	235	190	210	230	180	190
0048 HRLY 01	US-95A, .6 mi S of the RxB crossing at Wabuska.									
	2300	2460	2400	2500	2650	3000	3000	2800*	3000*	2970*

LYON COUNTY

TABLE 3 - ANNUAL AVERAGE DAILY TRAFFIC AT PORTABLE TRAFFIC COUNT STATIONS -

STATION	1994	1995	1996	1997	1998	1999	2000	2001	2002	2003
0049 HRLY 02	US-95A, .5 mi N of the County Rd to Weed Heights.									
	3780	3765	3800	3900	4100	4400	4400	4300*	4500*	4450*
0051 HRLY 03	US-95A, 150' N of US-95A (Goldfield Av).									
	4965	4600	4700	4800	5100	5400	5300	5100	5450	5600
0052 HRLY 03	US-95A (Goldfield Av), .1 mi E of SR-339.									
	3955	4335	4350	4600	4700	5000	4800	4800	5050	4900
0053 HRLY 02	US-95A (Goldfield Av), 2 Blocks W of SR-208 (Main St).									
	4595	3775	3800	4000	4000	4250	4250*	4100*	4200*	4100*
0054 HRLY 03	SR-208 (Main St), 75' S of US-95A (Goldfield Av).									
	5150	5130	5250	5450	5700	6100	6100*	5800	6300	6000
0055 HRLY 03	US-95A, .2 mi E of Oregon St & .6 mi E of SR-208.									
	3145	3330	3450	3700	3600	3600	3600	3600	3900	3800
0056 HRLY 03	SR-208 (Main St), 150' N of SR-340 (Bridge St).									
	5240	5360	5460	5500	5400	5600	5750	5300	5600	5400
0058 HRLY 01	SR-340 (Bridge St), .1 mi W of SR-208 (Main St).									
	4230	4535	4250	4150	4300	4400	4600*	3900*	3900*	3800*
0059 HRLY 03	SR-208 (Main St), .1 mile S of SR-340 (Bridge St).									
	3770	3820	3605	4100	4100	4250	4250*	3900	4150	3800
0061 HRLY 03	SR-340 (Bridge St), .2 mi E of SR-339.									
	2500	3000	3050	2950	3050	3000	3150	2700	3000	2900
0063 HRLY 03	SR-339 (Nordyke Rd), .2 mi N of SR-827 (Mason Rd).									
	2435	2735	2900	2800	3000	3000	3000	2700	3200	3300
0064 HRLY 03	SR-339 (Nordyke Rd), 1 mile S of SR-827 in Mason.									
	1365	1540	1550	1400	1550	1600	1530	1500	1750	1950

LYON COUNTY

TABLE 3 - ANNUAL AVERAGE DAILY TRAFFIC AT PORTABLE TRAFFIC COUNT STATIONS -

STATION	1994	1995	1996	1997	1998	1999	2000	2001	2002	2003
0065 HRLY 03	SR-827 (Mason Rd), 400' W of SR-208 (Topaz-Yerington Rd).									
	870	810	855	800	800	800	830	770	1050	990
0066 HRLY 03	SR-208 (Topaz-Yerington Rd), 1.4 mi N of SR-827 (Mason Rd).									
	2035	1880	2670	2600	2650	2600	2600	2400	2750	2900
0067 HRLY 03	SR-827 (Cremetti Ln), .25 mi E of SR-208.									
	210	235	195	195	195	300	280	240	240	340
0072 HRLY 03	Pursel Ln, 2.3 mi E of SR-827 (McKenzie Ln).									
	40	40	40	45	45	40	40	40	40	30
0075 HRLY 03	SR-208 (Topaz-Yerington Rd), .6 mi N of MacKenzie Ln & .1 mi S of Fridhoff Ln.									
	475	350	435	450	475	570	510	470	610	600
0080 HRLY 03	SR-208 (Topaz-Yerington Rd), 100' N of Pine Grove Rd.									
	315	260	400	410	420	470	450	410	540	510
0081 HRLY 03	County Rd to the E Walker River Ranches, .25 mi S of SR-208.									
									40	30
0086 HRLY 03	SR-208 (Topaz-Yerington Rd), .3 mi E of leg of Wye to SR-824 in Smith.									
	1325	1530	1450	1550	1650	1600	1650	1600	1750	1850
0087 HRLY 03	SR-824 (Day Lane), 155' N of E leg of Wye to SR-208 & 293' S of SR-825.									
	1060	1070	1080	1080	970	1050	980	840	1000	1050
0089 HRLY 03	SR-825 (Gage Rd), in Smith .1 mi W of SR-824 (Day Ln).									
	215	175	180	220	220	175	170	160	180	160
0090 HRLY 03	SR-208 (Topaz-Yerington Rd), .2 mi N of SR-338 S of Smith.									
	1390	1570	1600	1550	1400*	1475	1400	1400	1650	1650
0091 HRLY 03	SR-208 (Topaz-Yerington Rd), .2 mi W of SR-338 S of Smith.									
	1215	1320	1400	1300	1350	1200	1200*	1200	1350	1350

LYON COUNTY

TABLE 3 - ANNUAL AVERAGE DAILY TRAFFIC AT PORTABLE TRAFFIC COUNT STATIONS -

STATION	1994	1995	1996	1997	1998	1999	2000	2001	2002	2003
0092 HRLY 03	SR-338 (Sweetwater Rd), .1 mi S of SR-208 S of Smith. 395	430	445	445	410	400	390	420	420	460
0094 HRLY 03	SR-208 (Topaz-Yerington Rd), .5 mi E of SR-823 to Colony District. 1635	1650	1950	1800	1850	1900	1500	1500	2050	2000
0095 HRLY 03	SR-823 (Colony District Rd), Lower Colony Rd .2 mi N of SR-208. 670	675	675	665	680	700	600*	590	720	760
0096 HRLY 03	SR-823 (Artesia Rd), .1 mi W of jct of SR-823 (Hunewell Ln) N of SR-824. 205	180	180	190	170	290	200	160	220	200
0097 HRLY 03	SR-824 (Day Ln), .2 mi E of SR-823 (Colony District Rd). 275	290	290	265	240	380	320	260	260	320
0098 HRLY 03	SR-824 (Day Ln), 1.5 mi N of SR-825 (Gage Rd) in Smith. 710	755	760	760	690	820	760*	760	790	790
0099 HRLY 03	SR-829 (Wellington Rd), 1.2 mi E of SR-208 (Topaz-Yerington Rd) S of Wellington. 275	285	385	385	380	360	280*	260	410	380
0100 HRLY 03	SR-338 (Sweetwater Rd), .1 mi N of SR-829 (Wellington Rd). 260	285	285	285	225	260	230	240	340	310
0101 HRLY 03	SR-338 (Sweetwater Rd), .15 mi S of SR-829 (Wellington Rd). 445	515	425	425	420	420	400	390	550	500
0103 HRLY 03	SR-338 (Sweetwater Rd), 3.9 mi S of the County Rd at mp 9.7. 270	230	285	285	280	275	260*	260	310	290
0108 HRLY 03	SR-208 (Topaz-Yerington Rd), 300' S of SR-827 (Mason Rd). 1095	1035	1240	1280	1350	1350	1250	1200	1390	1500
0109 HRLY 03	Ninth St, .2 mi E of US-95A. 1300								1300	1200

LYON COUNTY

TABLE 3 - ANNUAL AVERAGE DAILY TRAFFIC AT PORTABLE TRAFFIC COUNT STATIONS -

STATION	1994	1995	1996	1997	1998	1999	2000	2001	2002	2003
0110 HRLY 03	County Rd (Old US-95A), to Mason Vy Wildlife Mgt Area .2 mi N of US-95A.					250	200	190	360	310
0111 HRLY 03	US-95A, .45 mi E of Pete Hendricks Rd.				2500	2500	2300	2600	2450	2650
0112 HRLY 03	US-95A, .1 mi E of Miley Rd & .1 mi E of mp 7.				1650	1650	1600	1800	1850	1900
0113 HRLY 03	US-95A, .25 mi E of Bonanza Ln.				1100	1250	1200*	1300	1300	1350
0114 HRLY 02	IR-80, at mp LY3.				15705	15510	14400	15200	15590	15900
0115 HRLY 03	US-95A, btwn Miller Ln & Campbell Ln.				3500	3650	3500	3600	3900	3850
0116 HRLY 03	Weed Heights Rd, .5 mi W of US-95A.				1000	900	930	930	860	900
0117 HRLY 03	Pine Grove (Bodie Rd), .2 mi S of SR-208.				70	70	50	80	110	60
0118 HRLY 03	Gallagher Pass Rd (Campbell Ln), 5.1 mi W of US-95A.				40*	40*	40*	30	30	10
0119 HRLY 03	Hardy Ln, .3 mi N of Cottonwood Ln.				840	850	1300	1300	1400	1100
0121 HRLY 03	Fort Churchill Rd, .15 mi S of US-50 E of Dayton.				100	110	120	140*	140*	140*
0122 HRLY 99	Bridge St, .1 mi E of Charlotte Av in Yerington.				720	770	700	680*	600*	600*

LYON COUNTY

TABLE 3 - ANNUAL AVERAGE DAILY TRAFFIC AT PORTABLE TRAFFIC COUNT STATIONS -

STATION	1994	1995	1996	1997	1998	1999	2000	2001	2002	2003
0123 HRLY 03	Orchard St, E of Whitaker Av in Yerington.					40	40	40	40	50
0124 HRLY 02	Pearl St, 117' W of Oregon St in Yerington.					1000	1000*	1100*	1250*	1250*
0125 HRLY 03	Fir St, in Silver Springs E of US-95A.					830	800	920	940	850
0126 HRLY 03	Weeks-Ramsey Cutoff Rd, .1 mi S of US-50.					1800	1750	1800	1800	1900
0127 HRLY 02	Truckee Ln, .1 miles W of US-95A Spur in Fernley.					820	700	810*	820*	820*
0128 HRLY 02	Miller Ln, .1 mi E of US-95A.								620	640
3048 HRLY 03	Fifth St, .7 mi E of US-95A in Silver Springs at the RxR tracks.							510	660	640
3049 HRLY 03	Ninth St, .6 mi E of US-95A in Silver Springs at the RxR tracks.								1150	1150
3050 HRLY 03	Churchill Cy-Thomas Smelter Rd, 2.2 mi W of US-95A N of Wasbuska at US-95A Jct.							20	10	20
3051 HRLY 03	East Newlands Dr, .1 mile E of Lyon Dr at the RxR crossing.							1600	1500	1400
3052 HRLY 03	Salvador Dr, E of Lyon Dr at the RxR crossing (Fernley area).								390	480