

SEE ENLARGEMENT

SEE ENLARGEMENT

WADSWORTH-FERNLEY 46

EAST FERNLEY 48

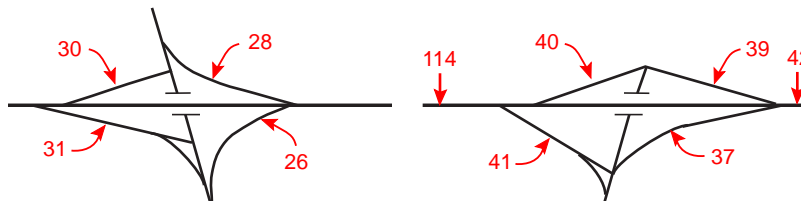

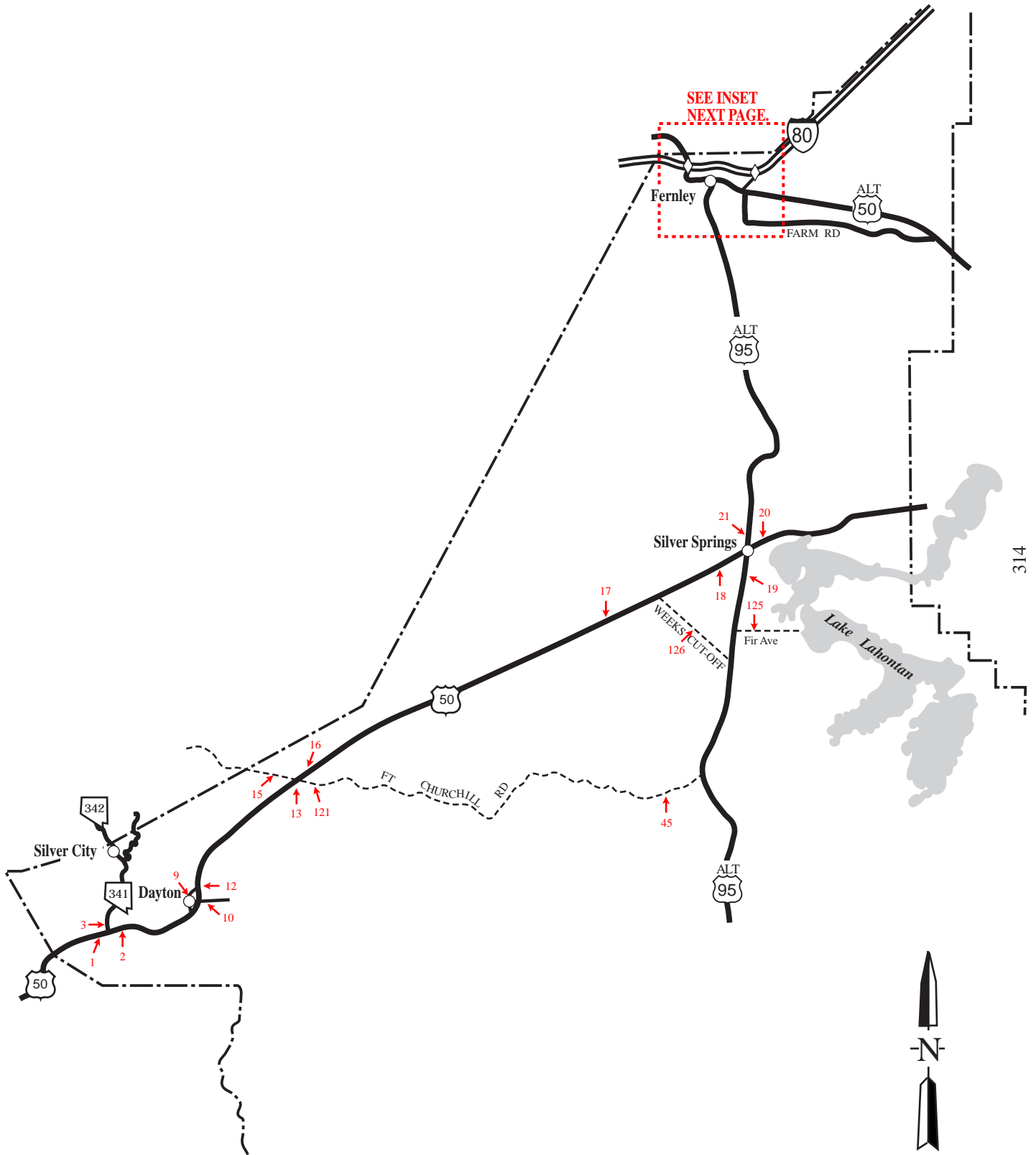

314

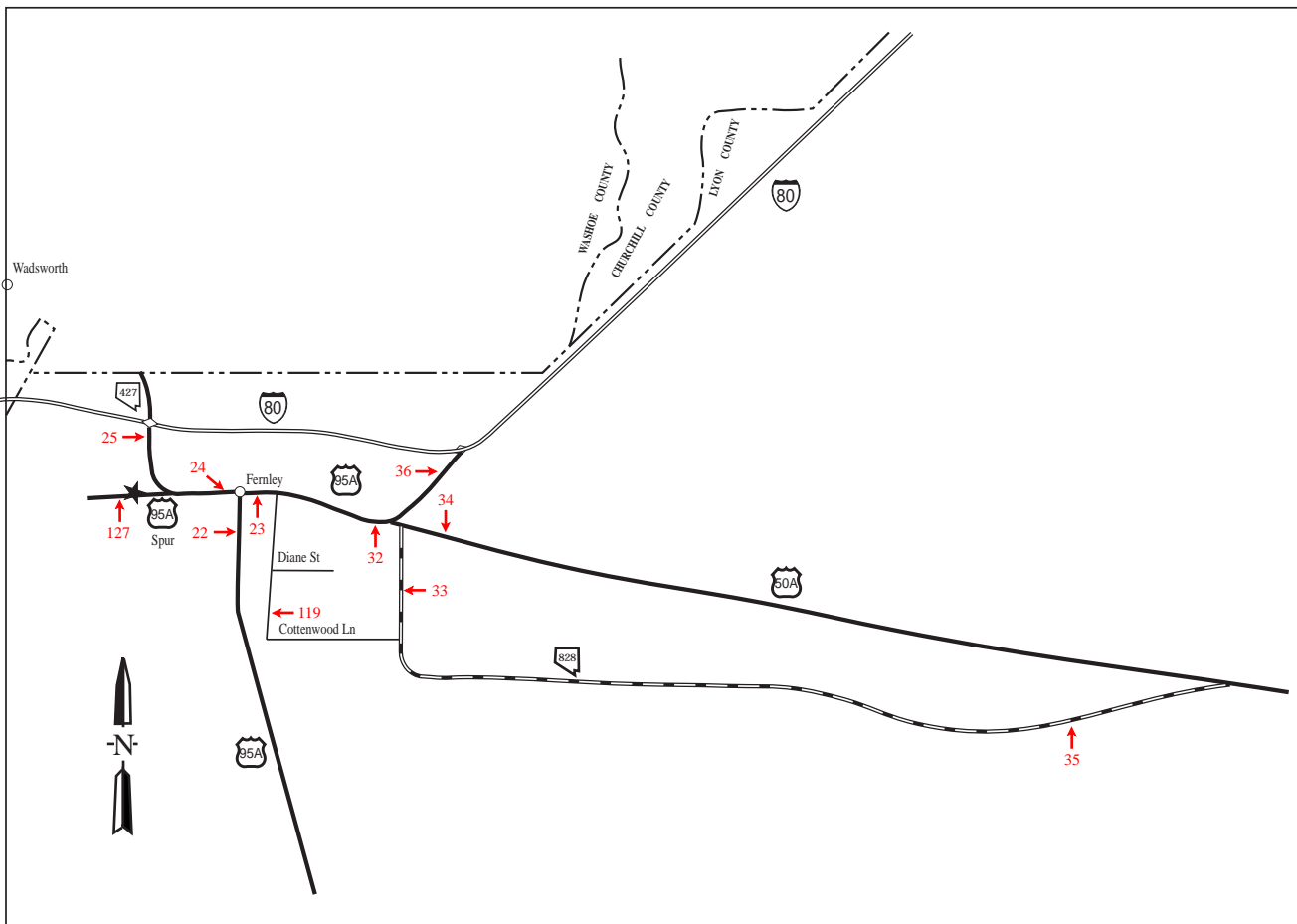

Wadsworth-Fernley
Enlarged Area

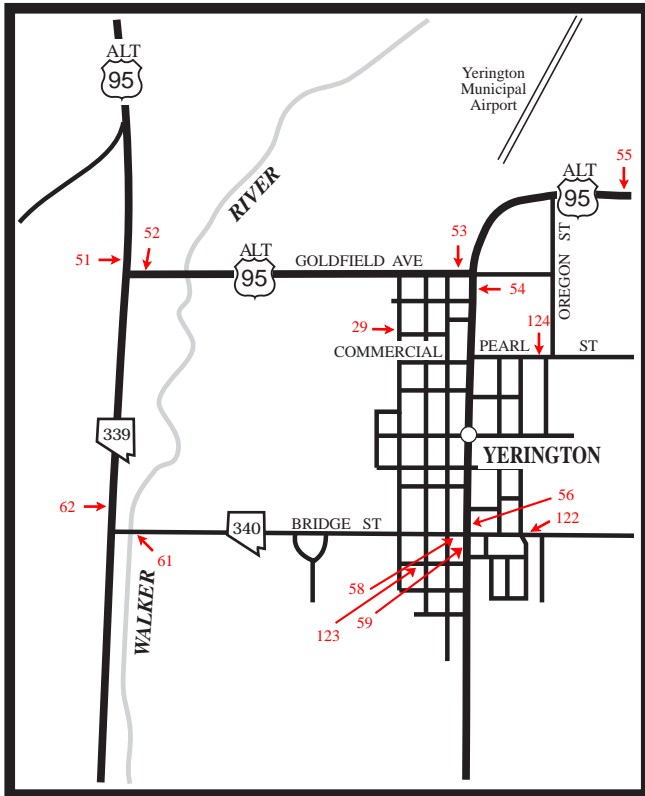

YERINGTON

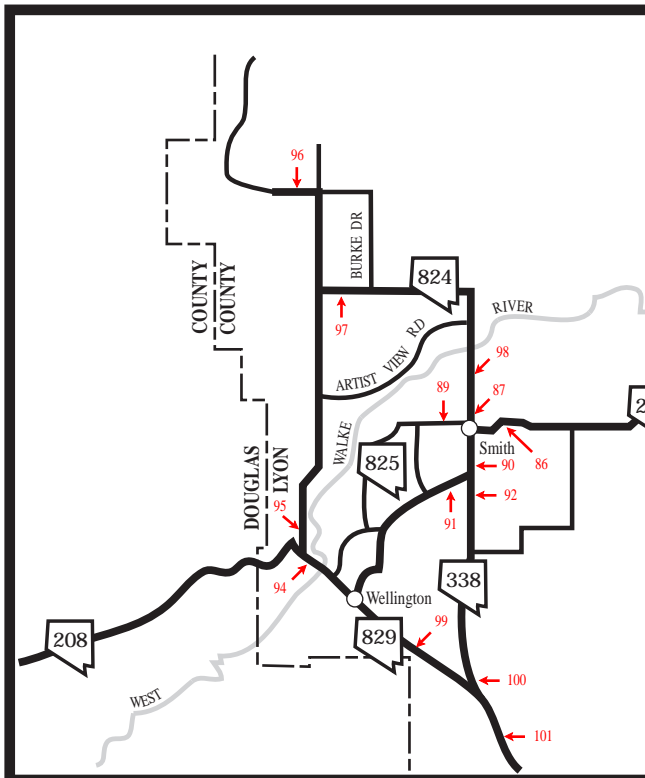
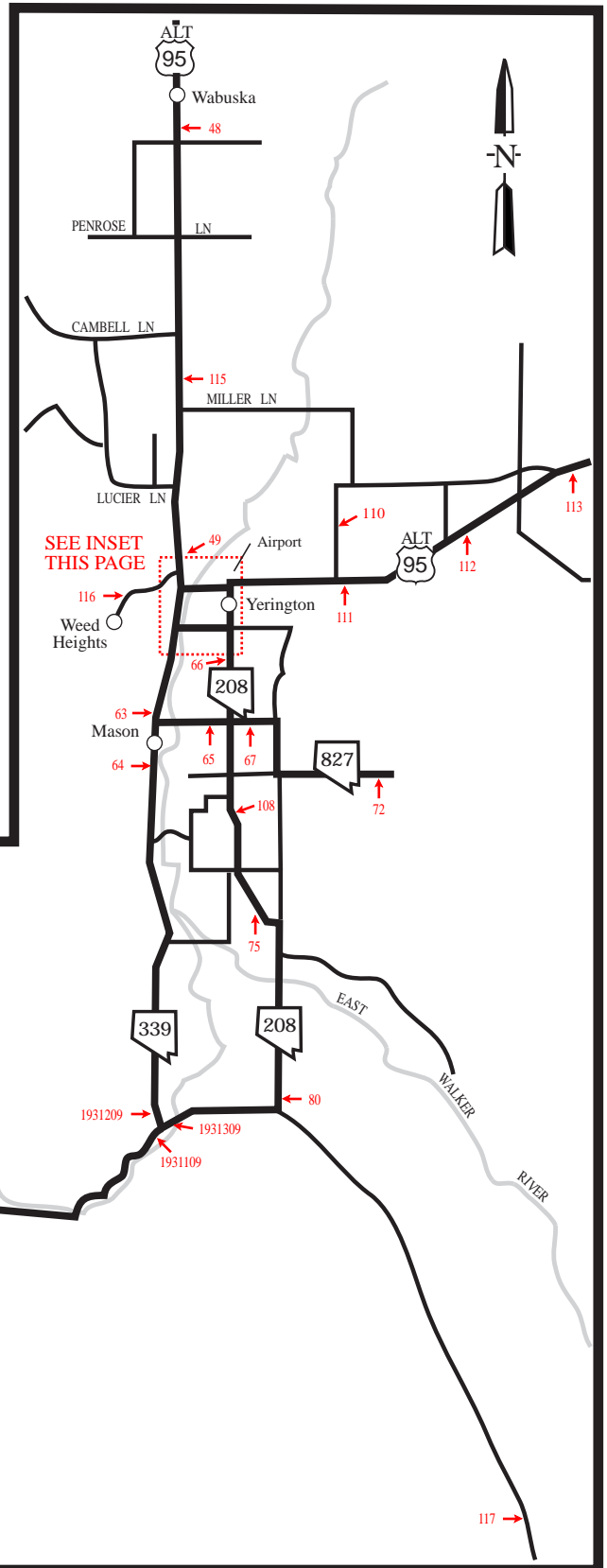

YERINGTON AREA

LYON COUNTY

TABLE 3 - ANNUAL AVERAGE DAILY TRAFFIC AT PORTABLE TRAFFIC COUNT STATIONS -

STATION	1993	1994	1995	1996	1997	1998	1999	2000	2001	2002						
0001 HRLY 02	US-50, .6 mi W of SR-341. 14700	16800	15700	15000	17100	17100	18500	18200	18600	21900						
0002 HRLY 02	US-50, .2 mi E of SR-341. 12000	14500	14800	14100	14200	14200	15900	15600*	15900	18600						
0003 HRLY 02	SR-341 (Virginia City Rd), 200' N of US-50. 2615	3045	3115	2450	2750	2800	3100	2950	2700	2700						
0009 HRLY 02	Pike St, 200' N of Main St in Dayton.						590	550	510	600						
0010 HRLY 02	Dayton Vy Rd, .1 mi E of US-50 in Dayton.						5955	5485	6220	6100	6400	6300	6300*	6500	6900*	6900*
0012 HRLY 02	US-50, .2 mi W of the entrance to the Dayton State Park.						8245	8790	9840	10700	11600	11600	14400	14400	14400	16700
0013 HRLY 02	US-50, at mp US-50-LY-10.						7050	7510	8350	8500	8900	8900	10200	10200	9900	12300
0014 HRLY 02	County Rd to Fort Churchill, 1.9 mi E of US-50.															80
0015 HRLY 01	Six Mile Cy Rd, 1.1 mi W of US-50.												1400	1450	1500*	1500*
0016 HRLY 02	US-50, .1 mi E of Chavez Rd.						4325	4610	4950	5550	5400	5400	6050	6000	5600*	6400*
0017 HRLY 02	US-50, .1 mi E of Cheyenne Rd (in Stage Coach) & 8.2 mi W of US-95A.						3400*	3600*	3950*	3950*	4400*	4800*	5000*	5000*	4900	5500
0018 HRLY 02	US-50, .7 mi W of US-95A at Silver Springs.						2700	3180	3170	3170	3400	3700	3850*	3850*	3400	4000

LYON COUNTY

TABLE 3 - ANNUAL AVERAGE DAILY TRAFFIC AT PORTABLE TRAFFIC COUNT STATIONS -

STATION	1993	1994	1995	1996	1997	1998	1999	2000	2001	2002
0019 HRLY 02	US-95A, at Silver Springs 200' S of US-50.									
	4090	5000	4760	5100	5300	5100	5300*	5200	5200	5700
0020 HRLY 02	US-50, 1.5 mi E of US-95A.									
	1600	1710	1790	1900	1800	2100	2000	2000*	1800	1950
0021 HRLY 99	US-95A, 270' N of US-50.									
	3685	4215	4055	4200	4150	4300	4600	4500	4900*	4900*
0022 HRLY 02	US-95A, 320' S of US-95A Spur in Fernley.									
	4700	5040	5153	5300	5700	6100	6400	6700	6600	7600
0023 HRLY 00	US-95A (Main St), 275' E of US-95A Spur.									
	7915	8355	8375	8500	9000	9400	9750	10200	10400*	10600*
0024 HRLY 02	US-95A Spur, 100' W of US-95A.									
	7220	8330	8270	9100	9000	9600	10200	10200*	11000	11400
0025 HRLY 02	US-95A Spur, 20' S of the RxB underpass btwn Fernley & Wadsworth.									
	5875	7185	7690	9050	8600	9200	9550	9400	9600	10900
0026 HRLY 03	IR-80, E/B on-ramp of the Wadsworth-W Fernley Intch 'Exit 46'.									
	375	470	580	905	880	1225	1160	1100	1000	900
0028 HRLY 03	IR-80, W/B off-ramp of the Wadsworth-W Fernley Intch 'Exit 46'.									
	445	565	600	740	780	1195	1130	1200	1100	900
0029 HRLY 02	Whitacre St, N of Commercial Av.									
							85	90	90	80
0030 HRLY 03	IR-80, W/B on-ramp of the Wadsworth-W Fernley Intch 'Exit 46' 375' W of SR-427.									
	2270	2590	3000	2840	2875	3115	2970	3600	3050	3440
0031 HRLY 02	IR-80, E/B off-ramp of the Wadsworth-W Fernley Intch 'Exit 46' 340' W of US-95A Spur.									
	2110	2420	2950	2885	3095	3170	3170	3780	3400	3650

LYON COUNTY

TABLE 3 - ANNUAL AVERAGE DAILY TRAFFIC AT PORTABLE TRAFFIC COUNT STATIONS -

STATION	1993	1994	1995	1996	1997	1998	1999	2000	2001	2002
0032 HRLY 02	US-95A, 200' W of US-50A to Hazen W of the Fernley overpass.									
	8065	8540	8560	8500	9600	10200	10700	11000	11200*	11400*
0033 HRLY 02	SR-828 (Fernley Farm District Rd), .2 mi S of US-50A.									
	2310	2435	2490	2500	2500	3600	3800	4050	4700	5550
0034 HRLY 01	US-50A, 2.6 mi E of SR-828.									
	5600*	5750*	5650*	6350*	7050*	7400*	7450*	7200	7900	8100
0035 HRLY 02	SR-828 (Fernley Farm District Rd), .25 mi W of US-50A.									
	190	250	210	270	270	270	340	330	380	510
0036 HRLY 02	US-95A, to IR-80 at the N end of guardrail of RxB overpass.									
	10800	11200	10800	12300	13000	13800	15600	15600*	16000	18100
0037 HRLY 03	IR-80, E/B on-ramp of the E Fernley Intch 'Exit 48' .2 mi from cross traffic rd.									
	1150	960	845	905	735	725	780	700	640	640
0039 HRLY 03	IR-80, W/B off-ramp of the E Fernley Intch 'Exit 48' 100' NE of the cross traffic rd.									
	1100	920	835	940	770	810	890	790	750	690
0040 HRLY 03	IR-80, W/B on-ramp of the E Fernley Intch 'Exit 48'.									
	3225	3665	3800	4060	3665	4995	5250	4670	4900	4910
0041 HRLY 03	IR-80, E/B off-ramp of the E Fernley Intch 'Exit 48' .1 mi from W end of ramp.									
	3365	3855	3665	3770	3890	4865	4980	4270	4600	4600
0042 HRLY 02	IR-80, at milepost LY 8.9 2.2 mi W of the Nightingale Intch 'Exit 65'.									
	6560	6350	6685	6085	6685	7380	6950	6950	7090	7410
0045 HRLY 02	Fort Churchill Rd, .2 mi W of US-95A.									
					235	235	190	210	230	180
0048 HRLY 01	US-95A, .6 mi S of the RxB crossing at Wabuska.									
	2125	2300	2460	2400	2500	2650	3000	3000	2800*	3000*

LYON COUNTY

TABLE 3 - ANNUAL AVERAGE DAILY TRAFFIC AT PORTABLE TRAFFIC COUNT STATIONS -

STATION	1993	1994	1995	1996	1997	1998	1999	2000	2001	2002
0049 HRLY 02	US-95A, .5 mi N of the County Rd to Weed Heights.									
	3415	3780	3765	3800	3900	4100	4400	4400	4300*	4500*
0051 HRLY 02	US-95A, 150' N of US-95A (Goldfield Av).									
	4670	4965	4600	4700	4800	5100	5400	5300	5100	5450
0052 HRLY 02	US-95A (Goldfield Av), .1 mi E of the NS portion of US-95A.									
	3960	3955	4335	4350	4600	4700	5000	4800	4800	5050
0053 HRLY 02	US-95A (Goldfield Av), 150' W of SR-208 (Main St).									
	4600	4595	3775	3800	4000	4000	4250	4250*	4100*	4200*
0054 HRLY 02	SR-208 (Main St), 75' S of US-95A (Goldfield Av).									
	4755	5150	5130	5250	5450	5700	6100	6100*	5800	6300
0055 HRLY 02	US-95A, .2 mi E of Oregon St & .6 mi E of SR-208.									
	2920	3145	3330	3450	3700	3600	3600	3600	3600	3900
0056 HRLY 02	SR-208 (Main St), 150' N of SR-340 (Bridge St).									
	5055	5240	5360	5460	5500	5400	5600	5750	5300	5600
0058 HRLY 01	SR-340 (Bridge St), .1 mi W of SR-208 (Main St).									
	3790	4230	4535	4250	4150	4300	4400	4600*	3900*	3900*
0059 HRLY 02	SR-208 (Main St), S of SR-340 (Bridge St).									
	3435	3770	3820	3605	4100	4100	4250	4250*	3900	4150
0061 HRLY 02	SR-340 (Bridge St), .2 mi E of SR-339.									
	2240	2500	3000	3050	2950	3050	3000	3150	2700	3000
0062 HRLY 02	SR-339 (Nordyke Rd), .2 mi N of SR-340 W of Yerington.									
	2665	2670	2745	2900	2900	3250	3300	3300*	3000	3400
0063 HRLY 02	SR-339 (Nordyke Rd), .2 mi N of SR-827 in Mason.									
	2260	2435	2735	2900	2800	3000	3000	3000	2700	3200

LYON COUNTY

TABLE 3 - ANNUAL AVERAGE DAILY TRAFFIC AT PORTABLE TRAFFIC COUNT STATIONS -

STATION	1993	1994	1995	1996	1997	1998	1999	2000	2001	2002
0064 HRLY 02	SR-339 (Nordyke Rd), 1 mile S of SR-827 in Mason.									
	1200	1365	1540	1550	1400	1550	1600	1530	1500	1750
0065 HRLY 02	SR-827 (Mason Rd), 400' W of SR-208 (Topaz-Yerington Rd).									
	675	870	810	855	800	800	800	830	770	1050
0066 HRLY 02	SR-208 (Topaz-Yerington Rd), 1.4 mi N of SR-827 (Mason Rd).									
	1600	2035	1880	2670	2600	2650	2600	2600	2400	2750
0067 HRLY 02	SR-827 (Cremetti Ln), .25 mi E of SR-208.									
	190	210	235	195	195	195	300	280	240	400
0072 HRLY 97	Pursel Ln, 2.3 mi E of SR-827 (McKenzie Ln).									
	45	40	40	40	45	45	40	40	40*	40*
0075 HRLY 02	SR-208 (Topaz-Yerington Rd), .6 mi N of MacKenzie Ln & .1 mi S of Fridhoff Ln.									
	360	475	350	435	450	475	570	510	470	610
0080 HRLY 02	SR-208 (Topaz-Yerington Rd), 100' N of Pine Grove Rd.									
	240	315	260	400	410	420	470	450	410	540
0081 HRLY 02	County Rd to the E Walker River Ranches, .25 mi S of SR-208.									
										40
0086 HRLY 02	SR-208 (Topaz-Yerington Rd), .3 mi E of leg of Wye to SR-824 at Smith.									
	1180	1325	1530	1450	1550	1650	1600	1650	1600	1750
0087 HRLY 02	SR-824 (Day Lane), 155' S of E leg of Wye to SR-208 & 293' S of SR-825.									
	945	1060	1070	1080	1080	970	1050	980	840	1000
0089 HRLY 02	SR-825 (Gage Rd), in Smith .1 mi W of SR-824 (Day Ln).									
	185	215	175	180	220	220	175	170	160	180
0090 HRLY 02	SR-208 (Topaz-Yerington Rd), .2 mi N of SR-338 S of Smith.									
	1155	1390	1570	1600	1550	1400*	1475	1400	1400	1650

LYON COUNTY

TABLE 3 - ANNUAL AVERAGE DAILY TRAFFIC AT PORTABLE TRAFFIC COUNT STATIONS -

STATION	1993	1994	1995	1996	1997	1998	1999	2000	2001	2002
0091 HRLY 02	SR-208 (Topaz-Yerington Rd), .2 mi W of SR-338 S of Smith. 980	1215	1320	1400	1300	1350	1200	1200*	1200	1350
0092 HRLY 02	SR-338 (Sweetwater Rd), .1 mi S of SR-208 S of Smith. 350	395	430	445	445	410	400	390	420	420
0094 HRLY 02	SR-208 (Topaz-Yerington Rd), .5 mi E of SR-823 to Colony District. 1180	1635	1650	1950	1800	1850	1900	1500	1500	2050
0095 HRLY 02	SR-823 (Colony District Rd), Lower Colony Rd .2 mi N of SR-208. 500	670	675	675	665	680	700	600*	590	720
0096 HRLY 02	SR-823 (Artesia Rd), .1 mi W of jct of SR-823 Hunewell Ln. 180	205	180	180	190	170	290	200	160	220
0097 HRLY 97	SR-824 (Day Ln), .2 mi E of SR-823 (Colony District Rd). 230	275	290	290	265	240	380	320	260*	260*
0098 HRLY 02	SR-824 (Day Ln), 1.5 mi N of SR-825 (Gage Rd) in Smith. 640	710	755	760	760	690	820	760*	760	790
0099 HRLY 02	SR-829 (Wellington Rd), 1.2 mi E of SR-208 (Topaz-Yerington Rd) S of Wellington. 210	275	285	385	385	380	360	280*	260	410
0100 HRLY 02	SR-338 (Sweetwater Rd), .1 mi N of SR-829 (Wellington Rd). 190	260	285	285	285	225	260	230	240	340
0101 HRLY 99	SR-338 (Sweetwater Rd), .15 mi S of SR-829 (Wellington Rd). 395	445	515	425	425	420	420	400	390*	550*
0103 HRLY 02	SR-338 (Sweetwater Rd), 3.9 mi S of the County Rd to Nye Cy at mp 9.7. 205	270	230	285	285	280	275	260*	260	310
0108 HRLY 99	SR-208 (Topaz-Yerington Rd), 300' S of SR-827 (Mason Rd). 925	1095	1035	1240	1280	1350	1350	1250	1200*	1390*

LYON COUNTY

TABLE 3 - ANNUAL AVERAGE DAILY TRAFFIC AT PORTABLE TRAFFIC COUNT STATIONS -

STATION	1993	1994	1995	1996	1997	1998	1999	2000	2001	2002
0109 HRLY 02	Ninth St., .1 mi E of US-95A.									
										1300
0110 HRLY 02	County Rd (Old US-95A), to Mason Vy Wildlife Mgt Area .2 mi N of US-95A.									
							250	200	190	360
0111 HRLY 02	US-95A, .45 mi E of Pete Hendricks Rd.									
	1970	2150	2340	2300	2250	2500	2500	2300	2600	2450
0112 HRLY 02	US-95A, .1 mi E of Miley Rd .1 mi E of mp 7.									
	1210	1320	1565	1600	1650	1650	1650	1600	1800	1850
0113 HRLY 02	US-95A, .25 mi E of Bonanza Ln.									
	1125	1120	1230	1150	1200	1100	1250	1200*	1300	1300
0114 HRLY 02	IR-80, at mp 3.									
	10900	12130	12470	12070	12735	15705	15510	14400	15200	15590
0115 HRLY 02	US-95A, btwn Miller Ln & Campbell Ln.									
	2830	3115	3250	3350	3400	3500	3650	3500	3600	3900
0116 HRLY 02	Weed Heights Rd, .5 mi W of US-95A.									
	1105	1240	1040	1050	1100	1000	900	930	930	860
0117 HRLY 02	Pine Grove (Bodie Rd), .2 mi S of SR-208.									
	30	35	40	70	70	70	70	50	80	110
0118 HRLY 02	Gallagher Pass Rd (Campbell Ln), 5.1 mi W of US-95A.									
	15	40	105	105	105	105	105	30	30	10
0119 HRLY 00	Hardy Ln, .3 mi N of Cottonwood Ln.									
	758	795	755	980	865	840	850	1300	1300	1400
0121 HRLY 01	Fort Churchill Rd, .15 mi S of US-50 E of Dayton.									
	100	100	110	110	110	100	110	120	140*	140*

LYON COUNTY

TABLE 3 - ANNUAL AVERAGE DAILY TRAFFIC AT PORTABLE TRAFFIC COUNT STATIONS -

STATION	1993	1994	1995	1996	1997	1998	1999	2000	2001	2002
0122 HRLY 99	530	525	695	710	710	720	770	700	680	600
0123 HRLY 02							40	40	40	40
0124 HRLY 02							1000	1000*	1100	1250
0125 HRLY 02							830	800	920	940
0126 HRLY 01							1800	1750	1800*	1800*
0127 HRLY 02							820	700	810	820
0128 HRLY 02										620
3048 HRLY 02									510	660
3049 HRLY 02										1150
3050 HRLY 02									20	10
3051 HRLY 02									1600	1500
3052 HRLY 02										390

