

SEE ENLARGEMENT

SEE ENLARGEMENT

WADSWORTH-FERNLEY 46

EAST FERNLEY 48

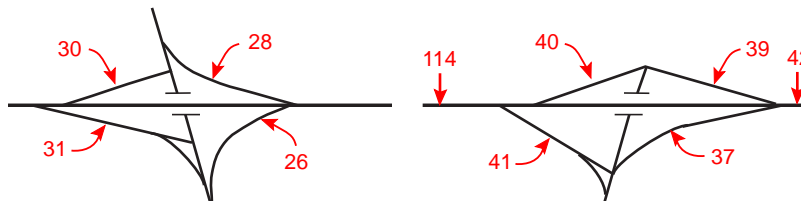

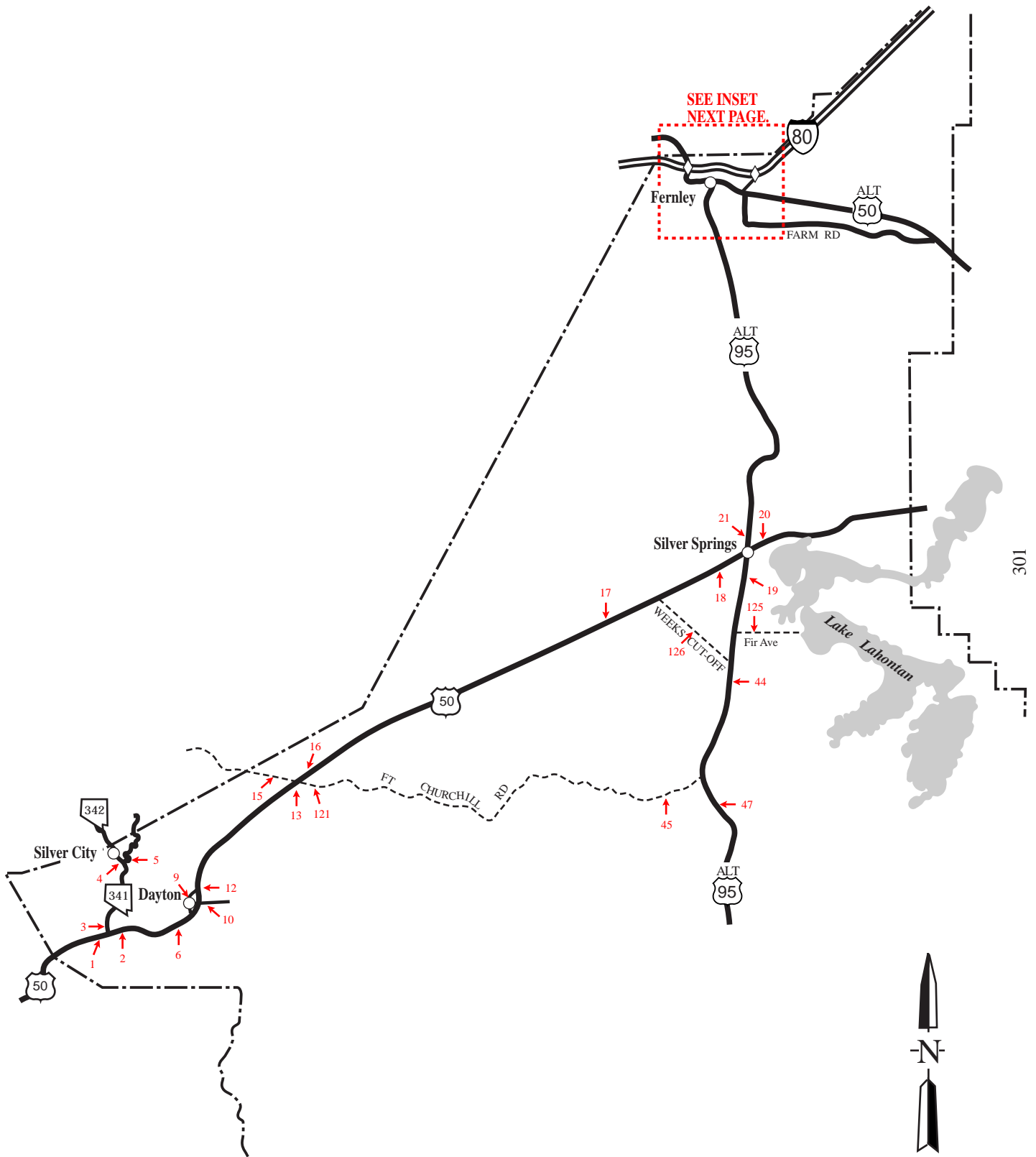

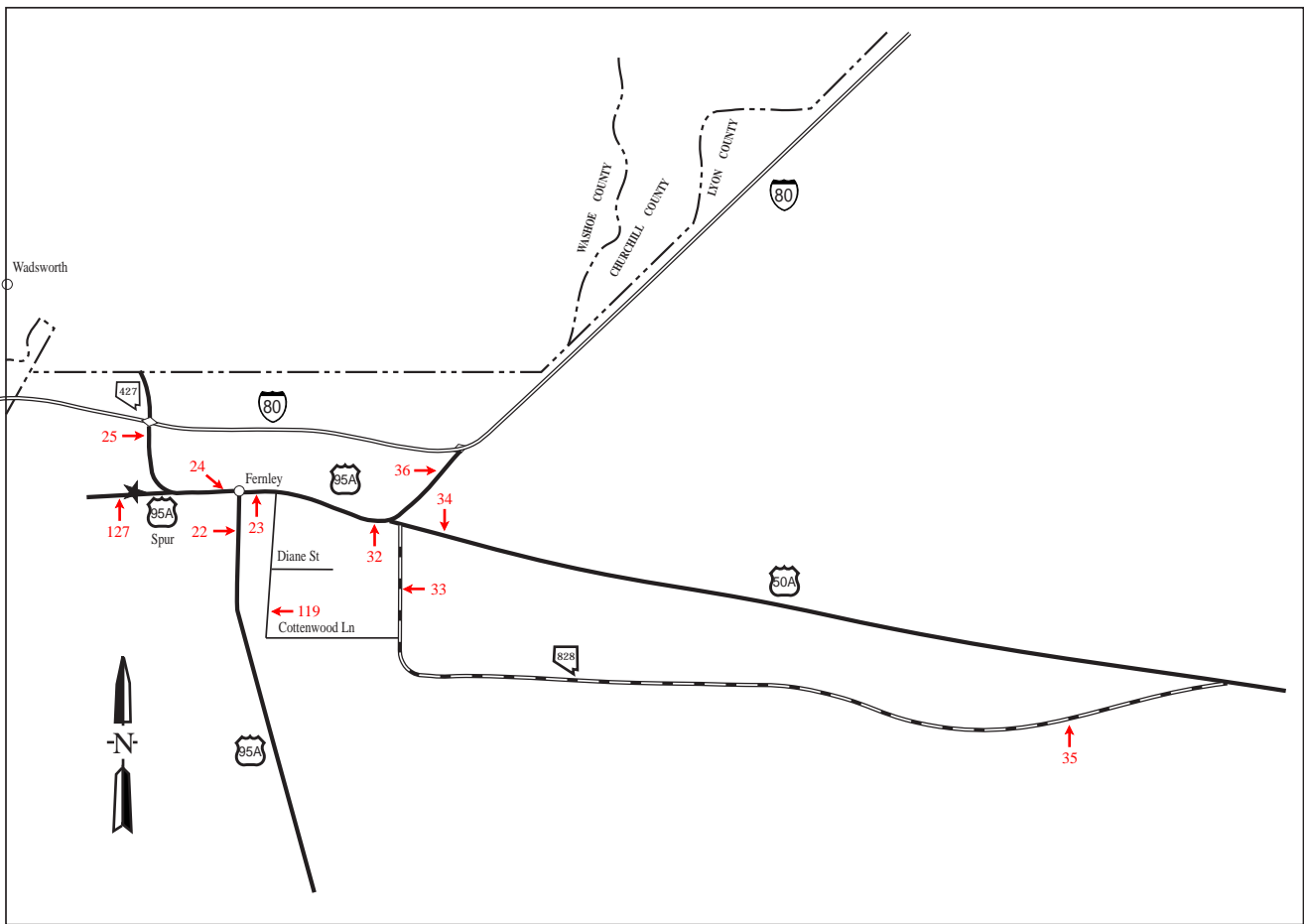

Wadsworth-Fernley
Enlarged Area

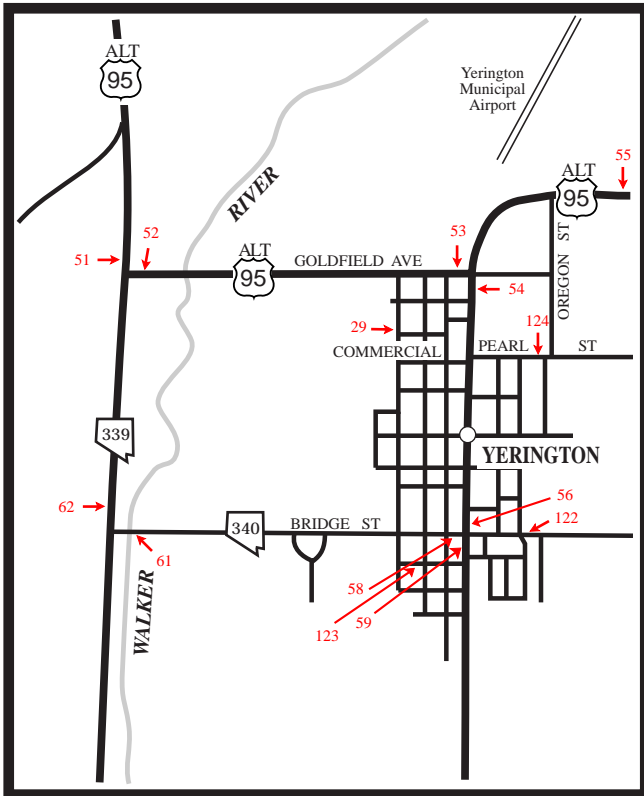

YERINGTON

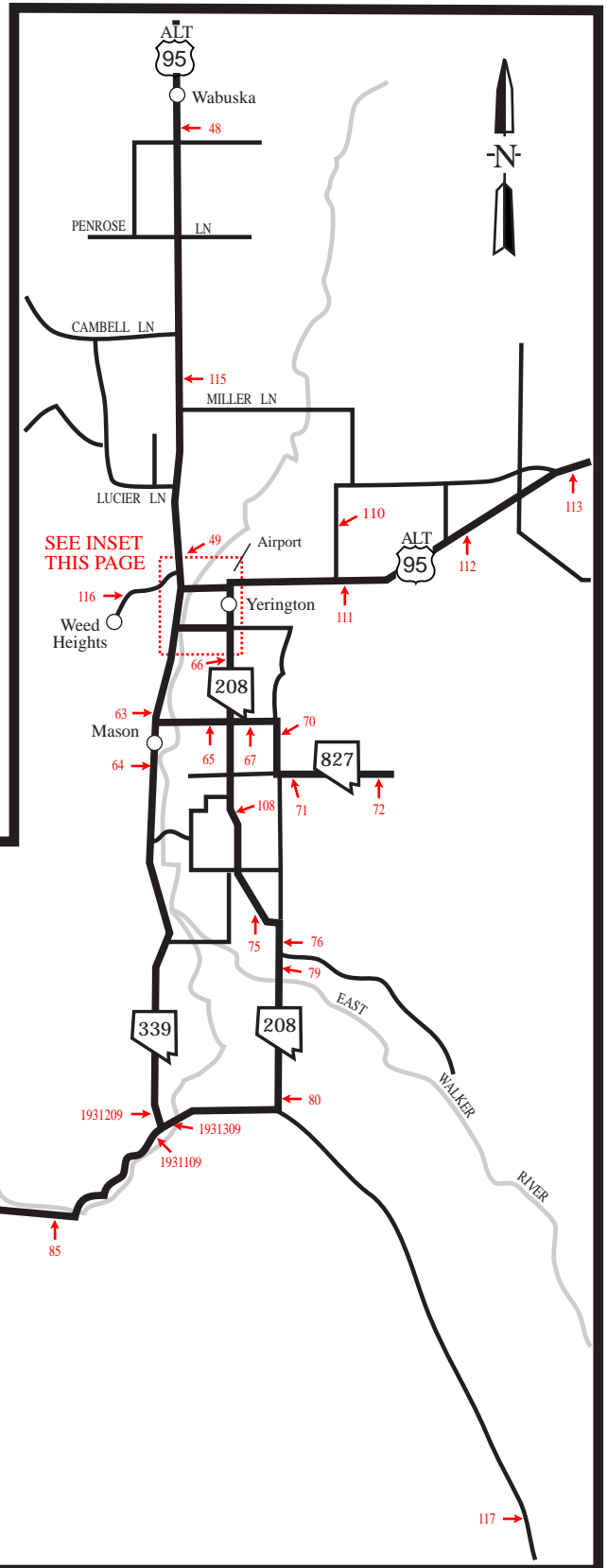

YERINGTON AREA

LYON COUNTY

TABLE 3 - ANNUAL AVERAGE DAILY TRAFFIC AT PORTABLE TRAFFIC COUNT STATIONS -

STATION	1992	1993	1994	1995	1996	1997	1998	1999	2000	2001
0001 HRLY 00	US-50, .3 mi W of SR-341. 13950	14700	16800	15700	15000	17100	17100	18500	18200	18600*
0002 HRLY 00	US-50, .2 mi E of SR-341. 11300	12000	14500	14800	14100	14200	14200	15900	15600*	15900*
0003 HRLY 01	SR-341 (Virginia City Rd), 200' N of US-50. 2550	2615	3045	3115	2450	2750	2800	3100	2950	2700
0004 HRLY 01	SR-342 (Silver City-Gold Hill Rd), .25 mi N of SR-341. 2445	2410	2075	2075	2050	2000	2050	1800	1900	2200
0005 HRLY 97	SR-341 (Virginia City Rd), .1 mi N of SR-342. 320	325	330	330	350	350	310	300	300	300*
0006 HRLY 00	US-50, .1 mi W of River St. 11500	11550	13400	14900	13300	14500	14500	15900	15600	16000
0009 HRLY 01	Pike St, 200' N of Main St in Dayton.							590	550	510
0010 HRLY 01	Dayton Vy Rd, .1 mi E of US-50 in Dayton. 4750	5955	5485	6220	6100	6400	6300	6300*	6500	6900
0012 HRLY 00	US-50, .2 mi W of the entrance to the Dayton State Park. 6800	8245	8790	9840	10700	11600	11600	14400	14400	14400*
0013 HRLY 01	US-50, at mp US-50-LY-10. 6400	7050	7510	8350	8500	8900	8900	10200	10200	9900
0015 HRLY 01	Six Mile Cy Rd, 1.1 mi W of US-50.							1400	1450	1500
0016 HRLY 01	US-50, .1 mi E of Chavez Rd. 3960	4325	4610	4950	5550	5400	5400	6050	6000	5600

LYON COUNTY

TABLE 3 - ANNUAL AVERAGE DAILY TRAFFIC AT PORTABLE TRAFFIC COUNT STATIONS -

STATION	1992	1993	1994	1995	1996	1997	1998	1999	2000	2001
0017 HRLY 01	US-50, .1 mi E of Cheyenne Rd (in Stage Coach) & 8.2 mi W of US-95A.									
	3490*	3400*	3600*	3950*	3950*	4400*	4800*	5000*	5000*	4900
0018 HRLY 01	US-50, .7 mi W of US-95A at Silver Springs.									
	2665	2700	3180	3170	3170	3400	3700	3850*	3850*	3400
0019 HRLY 00	US-95A, at Silver Springs 200' S of US-50.									
	3555	4090	5000	4760	5100	5300	5100	5300*	5200	5200
0020 HRLY 01	US-50, 1.5 mi E of US-95A.									
	1495	1600	1710	1790	1900	1800	2100	2000	2000*	1800
0021 HRLY 99	US-95A, 270' N of US-50.									
	2975	3685	4215	4055	4200	4150	4300	4600	4500	4900
0022 HRLY 01	US-95A, 320' S of US-95A Spur in Fernley.									
	4840	4700	5040	5153	5300	5700	6100	6400	6700	6600
0023 HRLY 00	US-95A (Main St), 275' E of US-95A Spur.									
	7775	7915	8355	8375	8500	9000	9400	9750	10200	10400*
0024 HRLY 01	US-95A Spur, 100' W of US-95A.									
	7115	7220	8330	8270	9100	9000	9600	10200	10200*	11000
0025 HRLY 00	US-95A Spur, 20' S of the RxR underpass btwn Fernley & Wadsworth.									
	5890	5875	7185	7690	9050	8600	9200	9550	9400	9600*
0026 HRLY 01	IR-80, E/B on-ramp of the Wadsworth-W Fernley Intch "Exit 44".									
	310	375	470	580	905	880	1225	1160	1100	1000
0028 HRLY 01	IR-80, W/B off-ramp of the Wadsworth-W Fernley Intch "Exit 44".									
	320	445	565	600	740	780	1195	1130	1200	1100
0029 HRLY 01	Whitacre St, N of Commercial Av.									
								85	90	90

LYON COUNTY

TABLE 3 - ANNUAL AVERAGE DAILY TRAFFIC AT PORTABLE TRAFFIC COUNT STATIONS -

STATION	1992	1993	1994	1995	1996	1997	1998	1999	2000	2001
0030 HRLY 01	IR-80, W/B on-ramp of the Wadsworth-W Fernley Intch "Exit 44", 375' W of SR-427. 1975	2270	2590	3000	2840	2875	3115	2970	3600	3050
0031 HRLY 01	IR-80, E/B off-ramp of the Wadsworth-W Fernley Intch "Exit 44" 340' W of US-95A Spur. 2015	2110	2420	2950	2885	3095	3170	3170	3780	3400
0032 HRLY 00	US-95A, 200' W of US-50A to Hazen W of the Fernley overpass. 7430	8065	8540	8560	8500	9600	10200	10700	11000	11200*
0033 HRLY 01	SR-828 (Fernley Farm District Rd), .2 mi S of US-50A. 2150	2310	2435	2490	2500	2500	3600	3800	4050	4700
0034 HRLY 01	US-50A, 2.6 mi E of SR-828. 5570*	5600*	5750*	5650*	6350*	7050*	7400*	7450*	7200	7900
0035 HRLY 01	SR-828 (Fernley Farm District Rd), .25 mi W of US-50A. 230	190	250	210	270	270	270	340	330	380
0036 HRLY 01	US-95A, to IR-80 at the N end of guardrail of R x R overpass. 9285	10800	11200	10800	12300	13000	13800	15600	15600*	16000
0037 HRLY 01	IR-80, E/B on-ramp of the E Fernley Intch "Exit 48" .2 mi from cross traffic rd. 965	1150	960	845	905	735	725	780	700	640
0039 HRLY 01	IR-80, W/B off-ramp of the E Fernley Intch "Exit 48" 100' NE of the cross traffic rd. 845	1100	920	835	940	770	810	890	790	750
0040 HRLY 01	IR-80, W/B on-ramp of the E Fernley Intch "Exit 48" .2 mi W of the cross traffic rd. 2730	3225	3665	3800	4060	3665	4995	5250	4670	4900
0041 HRLY 01	IR-80, E/B off-ramp of the E Fernley Intch "Exit 48" .1 mi from W end of ramp. 2800	3365	3855	3665	3770	3890	4865	4980	4270	4600
0042 HRLY 01	IR-80, 2.2 mi W of the Nightingale Intch "Exit 65". 6840	6560	6350	6685	6085	6685	7380	6950	6950	7090*

LYON COUNTY

TABLE 3 - ANNUAL AVERAGE DAILY TRAFFIC AT PORTABLE TRAFFIC COUNT STATIONS -

STATION	1992	1993	1994	1995	1996	1997	1998	1999	2000	2001
0044 HRLY 01	US-95A, 2.6 mi S of the Weeks Cutoff.									
	2250	2490	2845	2790	2650	2650	2700	3000	3000	2700
0045 HRLY 00	Fort Churchill Rd, .2 mi W ofUS-95A.									
						235	235	190	210*	230
0047 HRLY 01	US-95A, 4.9 mi S of Fort Churchill Rd.									
	2100	2325	2600	2415	2350	2400	2600	2850	2800	2600
0048 HRLY 01	US-95A, .6 mi S of the RxR crossing at Wabuska.									
	1890	2125	2300	2460	2400	2500	2650	3000	3000	2800
0049 HRLY 01	US-95A, .5 mi N of the County Rd to Weed Heights.									
	3065	3415	3780	3765	3800	3900	4100	4400	4400	4300
0051 HRLY 01	US-95A, 150' N of US-95A (Goldfield Av).									
	4365	4670	4965	4600	4700	4800	5100	5400	5300	5100
0052 HRLY 01	US-95A (Goldfield Av), .1 mi E of the NS portion of US-95A.									
	3710	3960	3955	4335	4350	4600	4700	5000	4800	4800
0053 HRLY 01	US-95A (Goldfield Av), 150' W of SR-208 (Main St).									
	3775	4600	4595	3775	3800	4000	4000	4250	4250*	4100
0054 HRLY 01	SR-208 (Main St), 75' S of US-95A (Goldfield Av).									
	4525	4755	5150	5130	5250	5450	5700	6100	6100*	5800
0055 HRLY 01	US-95A, .2 mi E of Oregon St & .6 mi E of SR-208.									
	2780	2920	3145	3330	3450	3700	3600	3600	3600	3600
0056 HRLY 01	SR-208 (Main St), 150' N of SR-340 (Bridge St).									
	4935	5055	5240	5360	5460	5500	5400	5600	5750	5300
0058 HRLY 01	SR-340 (Bridge St), .1 mi W of SR-208 (Main St).									
	3775	3790	4230	4535	4250	4150	4300	4400	4600*	3900

LYON COUNTY

TABLE 3 - ANNUAL AVERAGE DAILY TRAFFIC AT PORTABLE TRAFFIC COUNT STATIONS -

STATION	1992	1993	1994	1995	1996	1997	1998	1999	2000	2001
0059 HRLY 01	SR-208 (Main St), S of SR-340 (Bridge St). 3420	3435	3770	3820	3605	4100	4100	4250	4250*	3900
0061 HRLY 01	SR-340 (Bridge St), .2 mi E of SR-339. 2230	2240	2500	3000	3050	2950	3050	3000	3150	2700
0062 HRLY 01	SR-339 (Nordyke Rd), .2 mi N of SR-340 W of Yerington. 2375	2665	2670	2745	2900	2900	3250	3300	3300*	3000
0063 HRLY 99	SR-339 (Nordyke Rd), .2 mi N of SR-827 in Mason. 2060	2260	2435	2735	2900	2800	3000	3000	3000	2700
0064 HRLY 00	SR-339 (Nordyke Rd), .9 mi S of SR-827 in Mason. 1080	1200	1365	1540	1550	1400	1550	1600	1530	1500
0065 HRLY 99	SR-827 (Mason Rd), 400' W of SR-208 (Topaz-Yerington Rd). 685	675	870	810	855	800	800	800	830	770
0066 HRLY 99	SR-208 (Topaz-Yerington Rd), 1.4 mi N of SR-827 (Mason Rd). 1660	1600	2035	1880	2670	2600	2650	2600	2600	2400
0067 HRLY 99	SR-827 (Cremetti Ln), .25 mi E of SR-208. 200	190	210	235	195	195	195	300	280	240
0070 HRLY 99	SR-827 (McKenzie Ln), .1 mi S of the EW portion of SR-827 (Cremetti Ln). 225	295	250	220	265	265	265	290	260	260
0071 HRLY 97	Pursel Ln, .1 mi E of SR-827 (MacKenzie Ln). 275	270	190	220	220	225	225	370	220	230
0072 HRLY 97	Pursel Ln, 2.3 mi E of SR-827 (McKenzie Ln). 45	45	40	40	40	45	45	40	40	40
0075 HRLY 99	SR-208 (Topaz-Yerington Rd), .6 mi N of MacKenzie Ln & .1 mi S of Fridhoff Ln. 355	360	475	350	435	450	475	570	510	470

LYON COUNTY

TABLE 3 - ANNUAL AVERAGE DAILY TRAFFIC AT PORTABLE TRAFFIC COUNT STATIONS -

STATION	1992	1993	1994	1995	1996	1997	1998	1999	2000	2001
0076 HRLY 99	SR-208 (Topaz-Yerington Rd), .4 mi N of Walker Rd. 395	400	375	365	470	485	500	650	610	500
0079 HRLY 99	SR-208 (Topaz-Yerington Rd), .2 mi N of Hamer Ln. 355	355	380	330	445	460	490	570	510	460
0080 HRLY 99	SR-208 (Topaz-Yerington Rd), 100' N of E Walker Rd. 265	240	315	260	400	410	420	470	450	410
0085 HRLY 99	SR-208 (Topaz-Yerington Rd), 133' E of Hudson Wy. 930	915	1130	1310	1250	1350	1400	1300	1350	1300
0086 HRLY 00	SR-208 (Topaz-Yerington Rd), .3 mi E of leg of Wye to SR-824 at Smith. 1200	1180	1325	1530	1450	1550	1650	1600	1650	1600
0087 HRLY 00	SR-824 (Day Lane), 155' S of E leg of Wye to SR-208 & 293' S of SR-825. 975	945	1060	1070	1080	1080	970	1050	980	840
0088 HRLY 99	SR-824 (Day Ln), .15 mi N of SR-825 North of Smith. 850	770	840	910	920	920	790	850	790	690
0089 HRLY 97	SR-825 (Gage Rd), in Smith .1 mi W of SR-824 (Day Ln). 190	185	215	175	180	220	220	175	170	160
0090 HRLY 99	SR-208 (Topaz-Yerington Rd), .2 mi N of SR-338 S of Smith. 1160	1155	1390	1570	1600	1550	1400*	1475	1400	1400
0091 HRLY 99	SR-208 (Topaz-Yerington Rd), .2 mi W of SR-338 S of Smith. 975	980	1215	1320	1400	1300	1350	1200	1200*	1200
0092 HRLY 99	SR-338 (Sweetwater Rd), .1 mi S of SR-208 S of Smith. 325	350	395	430	445	445	410	400	390	420
0093 HRLY 99	SR-208 (Topaz-Yerington Rd), 440' W of SR-829 (Wellington Rd). 1175	1155	1620	1570	1750	1725	1800	1700	1500*	1300

LYON COUNTY

TABLE 3 - ANNUAL AVERAGE DAILY TRAFFIC AT PORTABLE TRAFFIC COUNT STATIONS -

STATION	1992	1993	1994	1995	1996	1997	1998	1999	2000	2001
0094 HRLY 96	SR-208 (Topaz-Yerington Rd), .5 mi E of SR-823 to Colony District. 1200	1180	1635	1650	1950	1800	1850	1900	1500*	1500
0095 HRLY 96	SR-823 (Colony District Rd), Lower Colony Rd .2 mi N of SR-208. 525	500	670	675	675	665	680	700	600*	590
0096 HRLY 97	SR-823 (Artesia Rd), .1 mi W of jct of SR-823 Hunewell Ln. 175	180	205	180	180	190	170	290	200	160
0097 HRLY 97	SR-824 (Day Ln), .2 mi E of SR-823 (Colony District Rd). 260	230	275	290	290	265	240	380	320	260
0098 HRLY 99	SR-824 (Day Ln), 1.5 mi N of SR-825 (Gage Rd) in Smith. 715	640	710	755	760	760	690	820	760*	760
0099 HRLY 99	SR-829 (Wellington Rd), 1.2 mi E of SR-208 (Topaz-Yerington Rd) S of Wellington. 250	210	275	285	385	385	380	360	280*	260
0100 HRLY 99	SR-338 (Sweetwater Rd), .1 mi N of SR-829 (Wellington Rd). 210	190	260	285	285	285	225	260	230	240
0101 HRLY 99	SR-338 (Sweetwater Rd), .15 mi S of SR-829 (Wellington Rd). 390	395	445	515	425	425	420	420	400	390
0103 HRLY 99	SR-338 (Sweetwater Rd), 3.9 mi S of the County Rd to Nye Cy at mp 9.7. 270	205	270	230	285	285	280	275	260*	260*
0105 HRLY 99	SR-338 (Sweetwater Rd), .5 mi S of the County Rd to Bodie S of mp 3. 160	150	250	245	305	305	300	290	280*	180
0108 HRLY 99	SR-208 (Topaz-Yerington Rd), 300' S of SR-827 (Mason Rd). 900	925	1095	1035	1240	1280	1350	1350	1250	1200
0110 HRLY 01	County Rd (Old US-95A), to Mason Vy Wildlife Mgt Area .3 mi N of US-95A. 250							250	200	190

LYON COUNTY

TABLE 3 - ANNUAL AVERAGE DAILY TRAFFIC AT PORTABLE TRAFFIC COUNT STATIONS -

STATION	1992	1993	1994	1995	1996	1997	1998	1999	2000	2001
0111 HRLY 01	US-95A, .45 mi E of Pete Hendricks Rd.									
	1900	1970	2150	2340	2300	2250	2500	2500	2300	2600
0112 HRLY 01	US-95A, .1 mi E of Miley Rd .1 mi E of mp 7.									
	1360	1210	1320	1565	1600	1650	1650	1650	1600	1800
0113 HRLY 01	US-95A, .25 mi E of Bonanza Ln.									
	1065	1125	1120	1230	1150	1200	1100	1250	1200*	1300
0114 HRLY 00	IR-80, at mp 3.									
	10560	10900	12130	12470	12070	12735	15705	15510	14400	15200*
0115 HRLY 01	US-95A, btwn Miller Ln & Campbell Ln.									
	2520	2830	3115	3250	3350	3400	3500	3650	3500	3600
0116 HRLY 01	Weed Heights Rd, .5 mi W of US-95A.									
		1105	1240	1040	1050	1100	1000	900	930	930*
0117 HRLY 99	Bodie Rd, .2 mi S of SR-208.									
		30	35	40	70	70	70	70	50	80
0118 HRLY 01	Gallagher Pass Rd (Campbell Ln), 5.1 mi W of US-95A.									
		15	40	105	105	105	105	105	30	30
0119 HRLY 00	Hardy Ln, .3 mi N of Cottonwood Ln.									
		758	795	755	980	865	840	850	1300	1300*
0121 HRLY 01	Fort Churchill Rd, .15 mi S of US-50 E of Dayton.									
		100	100	110	110	110	100	110	120	140
0122 HRLY 99	Bridge St, .1 mi E of Charlotte Av in Yerington.									
		530	525	695	710	710	720	770	700	680
0123 HRLY 01	Orchard St, E of Whitaker Av in Yerington.									
								40	40	40

