

Welcome to the Nevada Department of Transportation's Annual Traffic Report on the World-Wide-Web. This report contains a ten-year history (if available) of Annual Average Daily Traffic at statewide count locations. To reference these locations, proceed to the next page where you will find maps with the available sites. The locations are depicted in red with a station identification number. You will use this station identification number to reference the Table 3 section, which follows the maps.

Located on the left side of the report in the Table 3's, you will find the station identification number zero-filled to the fourth digit. See example below:

Example: station number 1 is 0001

 station number 33 is 0033

 station number 114 is 0114

If the station identification number is seven digits long, this is a continuous count location and will have to be referenced in the ATR's (Automatic Traffic Recorder's) section. The ATR section can be found at the beginning of the report, where the counties are listed.

All sites are listed in numeric order with a description of where the count was actually taken.

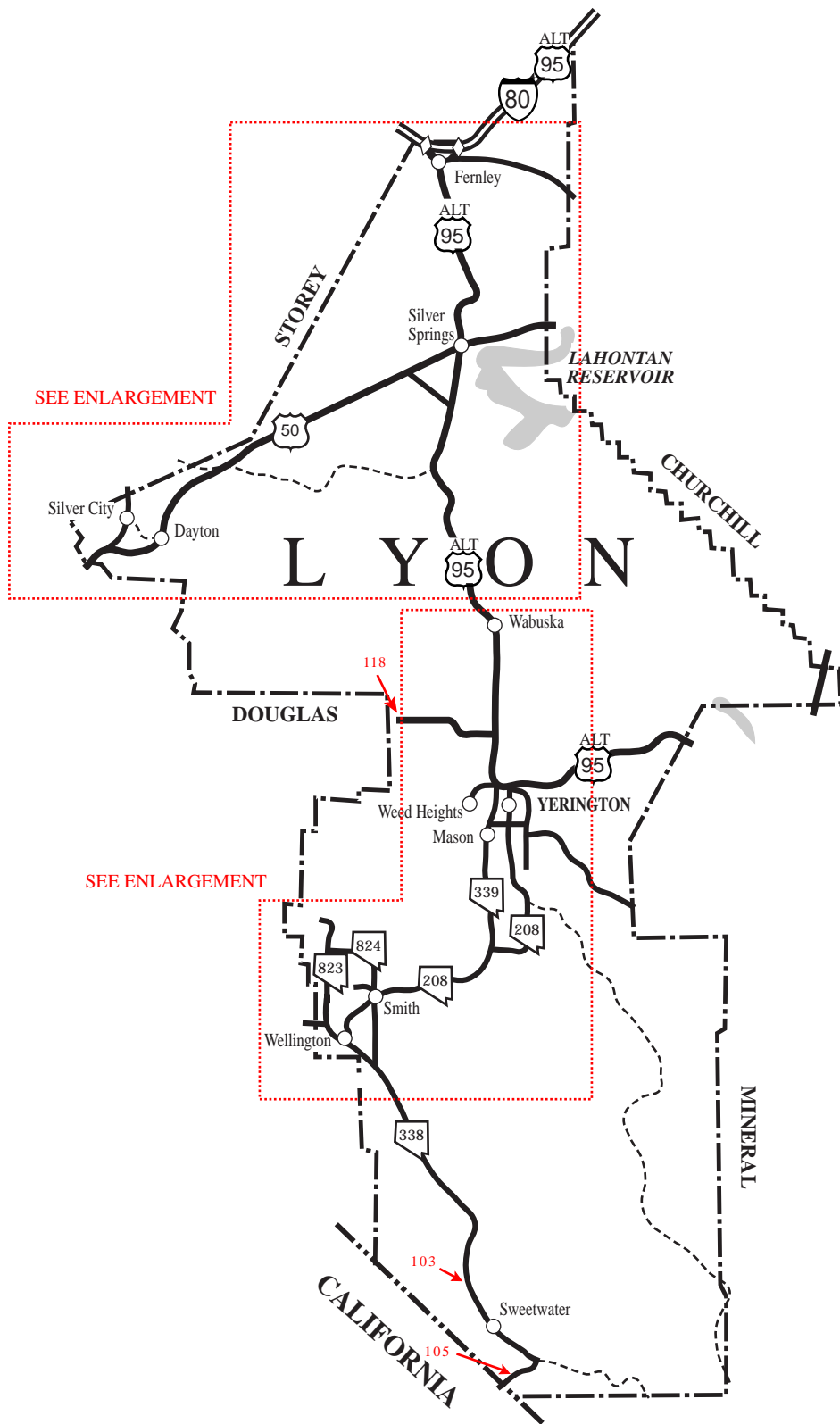

SEE ENLARGEMENT

SEE ENLARGEMENT

WADSWORTH-FERNLEY 46

EAST FERNLEY 48

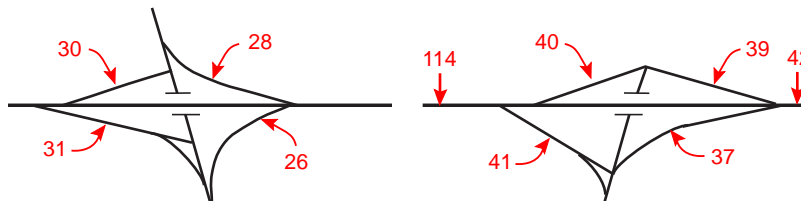

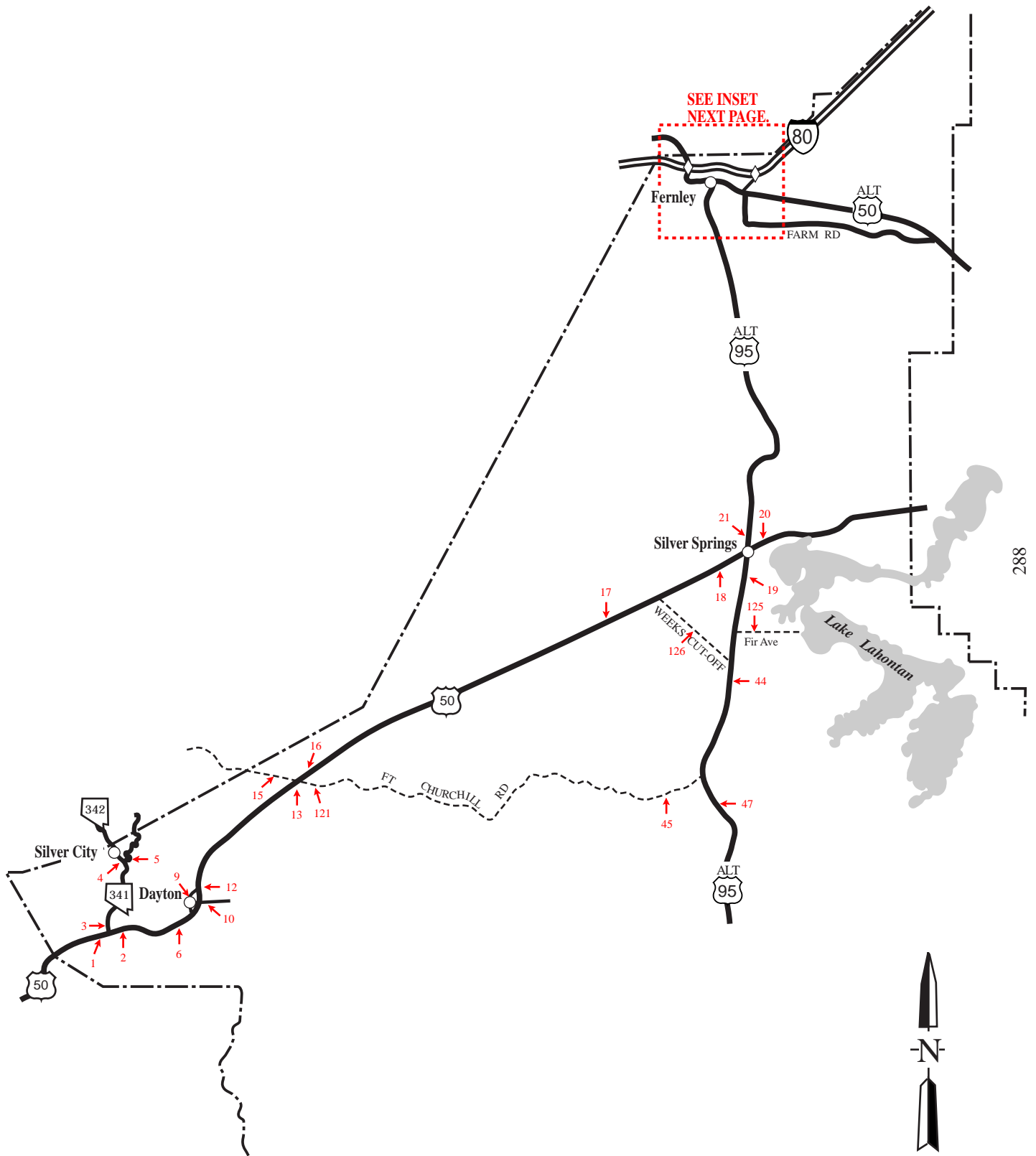

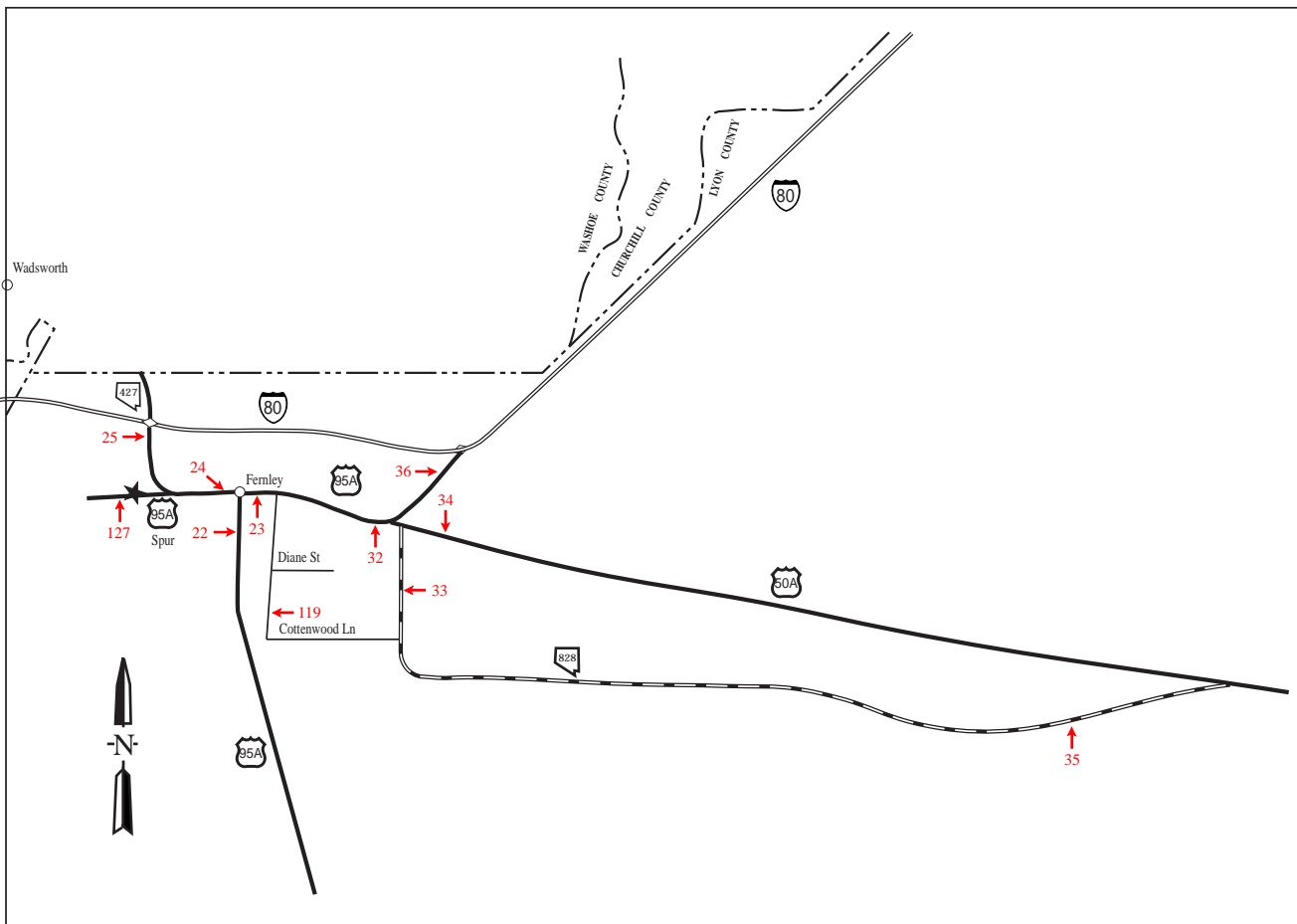

Wadsworth-Fernley
Enlarged Area

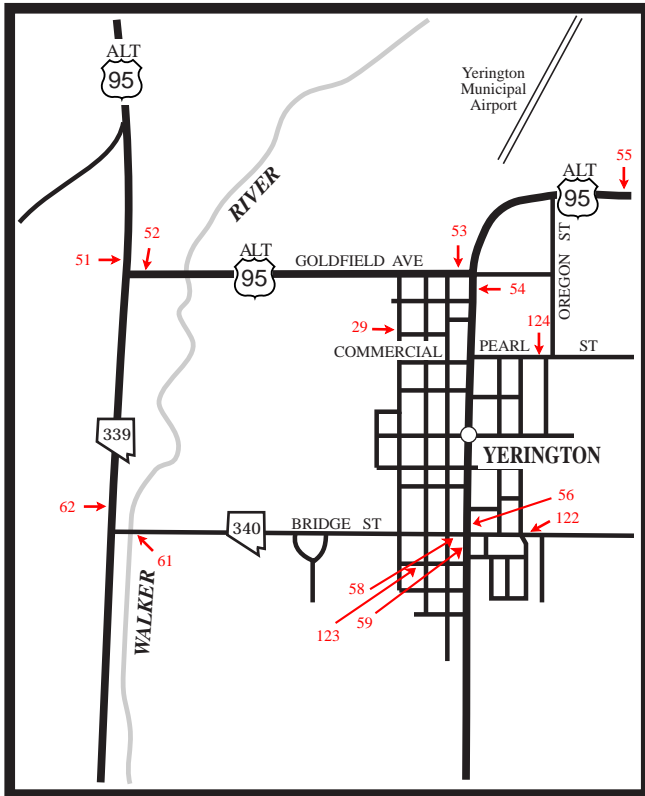

YERINGTON

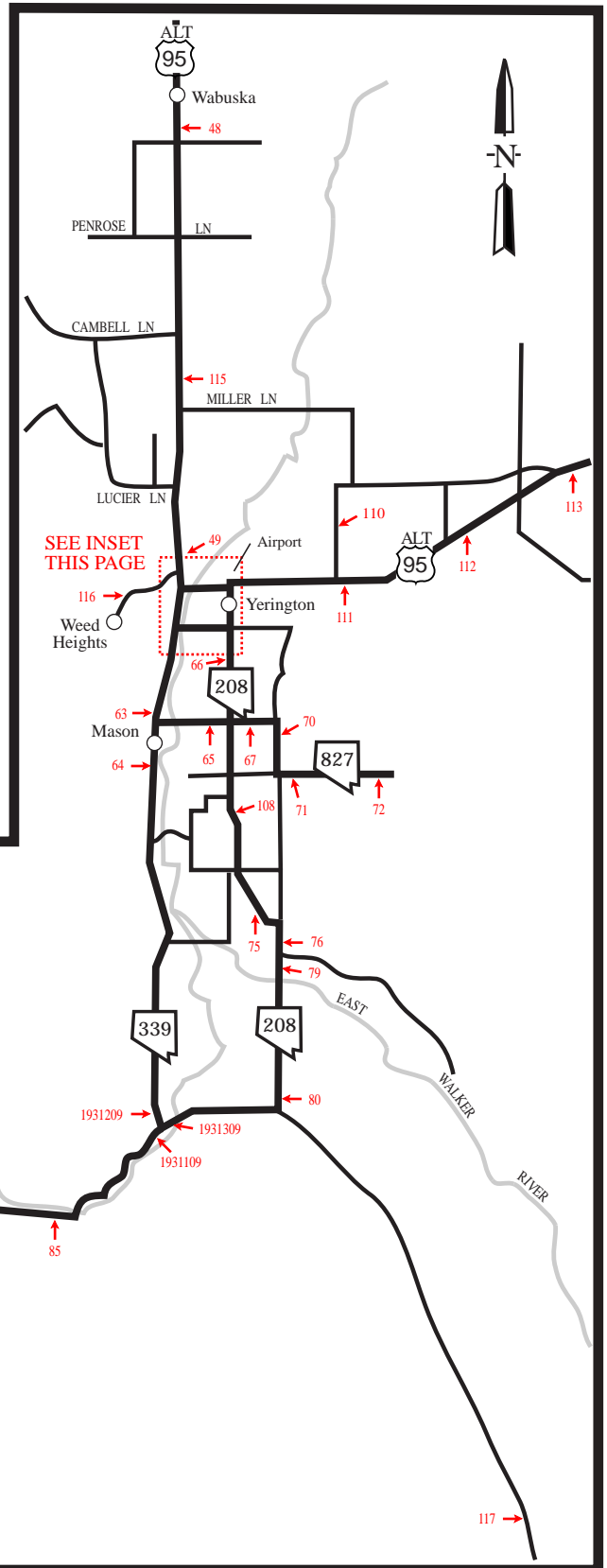

YERINGTON AREA

LYON COUNTY

TABLE 3 - ANNUAL AVERAGE DAILY TRAFFIC AT PORTABLE TRAFFIC COUNT STATIONS -

STATION	1991	1992	1993	1994	1995	1996	1997	1998	1999	2000
0001 HRLY 00	US-50, .3 mi W of SR-341. 12395	13950	14700	16800	15700	15000	17100	17100	18500	18200
0002 HRLY 00	US-50, .2 mi E of SR-341. 9030	11300	12000	14500	14800	14100	14200	14200	15900	15600
0003 HRLY 00	SR-341 (Virginia City Rd), 200' N of US-50. 2745	2550	2615	3045	3115	2450	2750	2800	3100	2950
0004 HRLY 00	SR-342 (Silver City-Gold Hill Rd), .25 mi N of SR-341. 2430	2445	2410	2075	2075	2050	2000	2050	1800	1900
0005 HRLY 97	SR-341 (Virginia City Rd), .1 mi N of SR-342. 260	320	325	330	330	350	350	310	300	300
0006 HRLY 00	US-50, .1 mi W of River St. 9230	11500	11550	13400	14900	13300	14500	14500	15900	15600
0009 HRLY 99	Pike St, 200' N of Main St in Dayton.								590	550
0010 HRLY 00	Dayton Valley Rd, .1 mi E of US-50, in Dayton. 4300	4750	5955	5485	6220	6100	6400	6300	6300*	6500
0012 HRLY 00	US-50, .2 mi W of the entrance to the Dayton State Park. 6565	6800	8245	8790	9840	10700	11600	11600	14400	14400
0013 HRLY 00	US-50, at mp US-50/LY-10. 5965	6400	7050	7510	8350	8500	8900	8900	10200	10200
0015 HRLY 00	Six Mile Canyon Rd, 1.1 mi W of US-50.								1400	1450
0016 HRLY 00	US-50, .1 mi E of Chavez Rd. 3730	3960	4325	4610	4950	5550	5400	5400	6050	6000

LYON COUNTY

TABLE 3 - ANNUAL AVERAGE DAILY TRAFFIC AT PORTABLE TRAFFIC COUNT STATIONS -

STATION	1991	1992	1993	1994	1995	1996	1997	1998	1999	2000
0017 HRLY 99	US-50, .1 mi E of Cheyenne Rd (in Stage Coach) & 8.2 mi W of US-95A.									
	3150	3490	3400*	3600*	3950*	3950*	4400*	4800*	5000*	5000
0018 HRLY 99	US-50, .7 mi W of US-95A at Silver Springs.									
	2425	2665	2700	3180	3170	3170	3400	3700	3850*	3850
0019 HRLY 00	US-95A, at Silver Springs, 200' S of US-50.									
	3075	3555	4090	5000	4760	5100	5300	5100	5300*	5200
0020 HRLY 99	US-50, 1.5 mi E of US-95A.									
	1365	1495	1600	1710	1790	1900	1800	2100	2000	2000
0021 HRLY 99	US-95A, 270' N of US-50.									
	2700	2975	3685	4215	4055	4200	4150	4300	4600	4500
0022 HRLY 00	US-95A, 320' S of US-95A Spur in Fernley.									
	4700	4840	4700	5040	5153	5300	5700	6100	6400	6700
0023 HRLY 00	US-95A (Main St), 275' E of US-95A Spur.									
	7600	7775	7915	8355	8375	8500	9000	9400	9750	10200
0024 HRLY 00	US-95A Spur, 100' W of US-95A.									
	6820	7115	7220	8330	8270	9100	9000	9600	10200	10200
0025 HRLY 00	US-95A Spur, 20' S of the RxR underpass, btwn Fernley & Wadsworth.									
	5690	5890	5875	7185	7690	9050	8600	9200	9550	9400
0026 HRLY 97	IR-80, E/B on-ramp of the Wadsworth-W Fernley Intch "Exit 44"									
	300	310	375	470	580	905	880	1225	1160	1100
0028 HRLY 97	IR-80, W/B off-ramp of the Wadsworth-W Fernley Intch "Exit 44".									
	320	320	445	565	600	740	780	1195	1130	1200
0029 HRLY 99	Whitacre St, N of Commercial Av.								85	90

LYON COUNTY

TABLE 3 - ANNUAL AVERAGE DAILY TRAFFIC AT PORTABLE TRAFFIC COUNT STATIONS -

STATION	1991	1992	1993	1994	1995	1996	1997	1998	1999	2000
0030 HRLY 97	IR-80, W/B on-ramp of the Wadsworth-W Fernley Intch "Exit 44", 375' W of SR-427.									
	2060	1975	2270	2590	3000	2840	2875	3115	2970	3600
0031 HRLY 99	IR-80, E/B off-ramp of the Wadsworth-W Fernley Intch "Exit 44", 340' W of US-95A Spur.									
	2090	2015	2110	2420	2950	2885	3095	3170	3170	3780
0032 HRLY 00	US-95A, 200' W of US-50A to Hazen, W of the Fernley overpass.									
	7090	7430	8065	8540	8560	8500	9600	10200	10700	11000
0033 HRLY 00	SR-828 (Fernley Farm District Rd), .2 mi S of US-50A.									
	2025	2150	2310	2435	2490	2500	2500	3600	3800	4050
0034 HRLY 00	US-50A, .2 mi E of SR-828.									
	4815	5570	5600*	5750*	5650*	6350*	7050*	7400*	7450*	7200
0035 HRLY 00	SR-828 (Fernley Farm District Rd), .25 mi W of US-50A.									
	220	230	190	250	210	270	270	270	340	330
0036 HRLY 99	US-95A, to I-80 at the N end of guardrail of RxR overpass.									
	8580	9285	10800	11200	10800	12300	13000	13800	15600	15600
0037 HRLY 97	IR-80, E/B on-ramp of the E Fernley Intch "Exit 48", .2 mi from cross traffic rd.									
	975	965	1150	960	845	905	735	725	780	700
0039 HRLY 97	IR-80, W/B off-ramp of the E Fernley Intch "Exit 48", 100' NE of the cross traffic rd.									
	905	845	1100	920	835	940	770	810	890	790
0040 HRLY 00	IR-80, W/B on-ramp of the E Fernley Intch "Exit 48", .2 mi W of the cross traffic rd.									
	2780	2730	3225	3665	3800	4060	3665	4995	5250	4670
0041 HRLY 00	IR-80, E/B off-ramp of the E Fernley Intch "Exit 48", .1 mi from W end of ramp.									
	2800	2800	3365	3855	3665	3770	3890	4865	4980	4270
0042 HRLY 00	IR-80, 2.2 mi W of the Nightingale Intch "Exit 65".									
	5935	6840	6560	6350	6685	6085	6685	7380	6950	6950

LYON COUNTY

TABLE 3 - ANNUAL AVERAGE DAILY TRAFFIC AT PORTABLE TRAFFIC COUNT STATIONS -

STATION	1991	1992	1993	1994	1995	1996	1997	1998	1999	2000
0044 HRLY 00	US-95A, 2.6 mi S of the Weeks Cutoff.									
	2025	2250	2490	2845	2790	2650	2650	2700	3000	3000
0045 HRLY 00	Fort Churchill Rd, .2 mi W of US-95A.									
							235	235	190	210
0047 HRLY 00	US-95A, 4.9 mi S of Fort Churchill Rd.									
	1905	2100	2325	2600	2415	2350	2400	2600	2850	2800
0048 HRLY 00	US-95A, .6 mi S of the RxR crossing at Wabuska.									
	1980	1890	2125	2300	2460	2400	2500	2650	3000	3000
0049 HRLY 98	US-95A, .5 mi N of the County Rd to Weed Heights.									
	3200	3065	3415	3780	3765	3800	3900	4100	4400	4400
0051 HRLY 99	US-95A, 150' N of US-95A (Goldfield Av).									
	4385	4365	4670	4965	4600	4700	4800	5100	5400	5300
0052 HRLY 98	US-95A (Goldfield Av), .1 mi E of the NS portion of US-95A.									
	3780	3710	3960	3955	4335	4350	4600	4700	5000	4800
0053 HRLY 98	US-95A (Goldfield Av), 150' W of SR-208 (Main St).									
	4020	3775	4600	4595	3775	3800	4000	4000	4250	4250
0054 HRLY 99	SR-208 (Main St), 75' S of US-95A (Goldfield Av).									
	4425	4525	4755	5150	5130	5250	5450	5700	6100	6100
0055 HRLY 00	US-95A, .2 mi E of Oregon St & .6 mi E of SR-208.									
	2880	2780	2920	3145	3330	3450	3700	3600	3600	3600
0056 HRLY 99	SR-208 (Main St), 150' N of SR-340 (Bridge St).									
	4690	4935	5055	5240	5360	5460	5500	5400	5600	5750
0058 HRLY 98	SR-340 (Bridge St), .1 mi W of SR-208 (Main St).									
	3725	3775	3790	4230	4535	4250	4150	4300	4400	4600

LYON COUNTY

TABLE 3 - ANNUAL AVERAGE DAILY TRAFFIC AT PORTABLE TRAFFIC COUNT STATIONS -

STATION	1991	1992	1993	1994	1995	1996	1997	1998	1999	2000
0059 HRLY 99	SR-208 (Main St), S of SR-340 (Bridge St).									
	3360	3420	3435	3770	3820	3605	4100	4100	4250	4250
0061 HRLY 99	SR-340 (Bridge St), .2 mi E of SR-339.									
	2265	2230	2240	2500	3000	3050	2950	3050	3000	3150
0062 HRLY 98	SR-339 (Nordyke Rd), .2 mi N of SR-340, W of Yerington.									
	2405	2375	2665	2670	2745	2900	2900	3250	3300	3300
0063 HRLY 99	SR-339 (Nordyke Rd), .2 mi N of SR-827 in Mason.									
	2160	2060	2260	2435	2735	2900	2800	3000	3000	3000
0064 HRLY 00	SR-339 (Nordyke Rd), .9 mi S of SR-827 in Mason.									
	1200	1080	1200	1365	1540	1550	1400	1550	1600	1530
0065 HRLY 99	SR-827 (Mason Rd), 400' W of SR-208.									
	595	685	675	870	810	855	800	800	800	830
0066 HRLY 99	SR-208 (Topaz-Yerington Rd), 1.4 mi N of SR-827 (Mason Rd).									
	1625	1660	1600	2035	1880	2670	2600	2650	2600	2600
0067 HRLY 99	SR-827 (Cremetti Ln), .25 mi E of SR-208.									
	215	200	190	210	235	195	195	195	300	280
0070 HRLY 99	SR-827 (McKenzie Ln), .1 mi S of the EW portion of SR-827 (Cremetti Ln).									
	230	225	295	250	220	265	265	265	290	260
0071 HRLY 97	Pursel Ln, .1 mi E of SR-827 (McKenzie Ln).									
	215	275	270	190	220	220	225	225	370	220
0072 HRLY 97	Pursel Ln, 2.3 mi E of SR-827 (McKenzie Ln).									
	45	45	45	40	40	40	45	45	40	40
0075 HRLY 99	SR-208 (Topaz-Yerington Rd), .6 mi N of McKenzie Ln & .1 mi S of Fridhoff Ln.									
	370	355	360	475	350	435	450	475	570	510

LYON COUNTY

TABLE 3 - ANNUAL AVERAGE DAILY TRAFFIC AT PORTABLE TRAFFIC COUNT STATIONS -

STATION	1991	1992	1993	1994	1995	1996	1997	1998	1999	2000
0076 HRLY 99	SR-208 (Topaz-Yerington Rd), 415	.4 mi E of Walker Rd. 395	400	375	365	470	485	500	650	610
0079 HRLY 99	SR-208 (Topaz-Yerington Rd), 390	.2 mi N of Hamer Ln. 355	355	380	330	445	460	490	570	510
0080 HRLY 99	SR-208 (Topaz-Yerington Rd), 295	100' N of E Walker Rd. 265	240	315	260	400	410	420	470	450
0085 HRLY 99	SR-208 (Topaz-Yerington Rd), 1065	133' E of Hudson Wy. 930	915	1130	1310	1250	1350	1400	1300	1350
0086 HRLY 00	SR-208 (Topaz-Yerington Rd), 1275	.3 mi E of leg of Wye to SR-824 at Smith. 1200	1180	1325	1530	1450	1550	1650	1600	1650
0087 HRLY 00	SR-824 (Day Lane), 975	155' S of E leg of Wye to SR-208 & 293' S of SR-825. 975	945	1060	1070	1080	1080	970	1050	980
0088 HRLY 99	SR-824 (Day Ln), 830	.15 mi N of SR-825, N of Smith. 850	770	840	910	920	920	790	850	790
0089 HRLY 97	SR-825 (Gage Rd), in Smith, 195	.1 mi W of SR-824. 190	185	215	175	180	220	220	175	170
0090 HRLY 99	SR-208 (Topaz-Yerington Rd), 1165	.2 mi N of SR-338, S of Smith. 1160	1155	1390	1570	1600	1550	1400*	1475	1400
0091 HRLY 99	SR-208 (Topaz-Yerington Rd), 980	.2 mi W of SR-338, S of Smith. 975	980	1215	1320	1400	1300	1350	1200	1200
0092 HRLY 99	SR-338 (Sweetwater Rd), 305	.1 mi S of SR-208, S of Smith. 325	350	395	430	445	445	410	400	390
0093 HRLY 99	SR-208 (Topaz-Yerington Rd), 1210	440' W of SR-829 in Wellington. 1175	1155	1620	1570	1750	1725	1800	1700	1700

LYON COUNTY

TABLE 3 - ANNUAL AVERAGE DAILY TRAFFIC AT PORTABLE TRAFFIC COUNT STATIONS -

STATION	1991	1992	1993	1994	1995	1996	1997	1998	1999	2000
0094 HRLY 96	SR-208 (Topaz-Yerington Rd), .5 mi E of SR-823 to Colony District.									
	1170	1200	1180	1635	1650	1950	1800	1850	1900	1900
0095 HRLY 96	SR-823 (Colony District Rd), Lower Colony Rd, .2 mi N of SR-208.									
	470	525	500	670	675	675	665	680	700	700
0096 HRLY 97	SR-823 (Artesia Rd), .1 mi W of jct of SR-823 Hunewell Ln.									
	175	175	180	205	180	180	190	170	290	200
0097 HRLY 97	SR-824 (Day Ln), .2 mi E of SR-823.									
	280	260	230	275	290	290	265	240	380	320
0098 HRLY 99	SR-824 (Day Ln), 1.5 mi N of SR-825 in Smith.									
	710	715	640	710	755	760	760	690	820	760
0099 HRLY 99	SR-829 (Wellington Rd), 1.2 mi E of SR-208, S of Wellington.									
	260	250	210	275	285	385	385	380	360	360
0100 HRLY 99	SR-338 (Sweetwater Rd), .1 mi N of SR-829 to Wellington.									
	155	210	190	260	285	285	285	225	260	230
0101 HRLY 99	SR-338 (Sweetwater Rd), .15 mi S of SR-829.									
	365	390	395	445	515	425	425	420	420	400
0103 HRLY 99	SR-338 (Sweetwater Rd), 3.9 mi S of the County Rd to Nye Canyon, mp SR-338 LY-9.7.									
	210	270	205	270	230	285	285	280	275	260
0105 HRLY 99	SR-338 (Sweetwater Rd), .5 mi S of the County Rd to Bodie.									
	225	160	150	250	245	305	305	300	290	280
0106	Old SR-3C, 1.4 mi S of the County Rd to Pine Grove Flat & 13.2 mi S of SR-208.									
									0	1250
0108 HRLY 99	SR-208 (Topaz-Yerington Rd), 300' S of SR-827 (Mason Rd).									
	990	900	925	1095	1035	1240	1280	1350	1350	1250

LYON COUNTY

TABLE 3 - ANNUAL AVERAGE DAILY TRAFFIC AT PORTABLE TRAFFIC COUNT STATIONS -

STATION	1991	1992	1993	1994	1995	1996	1997	1998	1999	2000	
0110 HRLY 99	County Rd (Old US-95A), to Mason Valley Wildlife Mgt Area, .3 mi N of US-95A.									250	200
0111 HRLY 98	US-95A, .45 mi E of Pete Hendricks Rd.										
	1945	1900	1970	2150	2340	2300	2250	2500	2500	2300	
0112 HRLY 98	US-95A, .1 mi E of Miley Rd, .1 mi E of mp US-95A/LY-7.										
	1420	1360	1210	1320	1565	1600	1650	1650	1650	1600	
0113 HRLY 98	US-95A, .25 mi E of Bonanza Ln.										
	1170	1065	1125	1120	1230	1150	1200	1100	1250	1200	
0114 HRLY 00	IR-80, at mp LY 3.										
	9635	10560	10900	12130	12470	12070	12735	15705	15510	14400	
0115 HRLY 98	US-95A, btwn Miller Ln & Campbell Ln, N of Yerington.										
	2605	2520	2830	3115	3250	3350	3400	3500	3650	3500	
0116 HRLY 99	Weed Heights Rd, .5 mi W of US-95A.										
			1105	1240	1040	1050	1100	1000	900	930	
0117 HRLY 99	Bodie Rd, .5 mi S of the County Rd to Pine Grove Flat, & .2 mi S of SR-208.										
			30	35	40	70	70	70	70	50	
0118	Gallagher Pass Rd (Campbell Lane), 7.2 mi W of US-95A.										
			15	40	105	105	105	105	105	30	
0119 HRLY 00	Hardy Ln, .25 mi N of Cottonwood Ln.										
			758	795	755	980	865	840	850	1300	
0121 HRLY 00	Fort Churchill Rd, .15 mi S of US-50, E of Dayton.										
			100	100	110	110	110	100	110	120	
0122 HRLY 99	Bridge St, .1 mi E of Charlotte Av, in Yerington.										
			530	525	695	710	710	720	770	700	

LYON COUNTY

TABLE 3 - ANNUAL AVERAGE DAILY TRAFFIC AT PORTABLE TRAFFIC COUNT STATIONS -

STATION	1991	1992	1993	1994	1995	1996	1997	1998	1999	2000
0123 HRLY 99	Orchard St, E of Whitacre Av in Yerington.								40	40
0124 HRLY 99	Pearl St, 117' W of Oregon St in Yerington.								1000	1000
0125 HRLY 00	Fir St, in Silver Springs, E of US-95A.								830	800
0126 HRLY 99	Weeks-Ramsey Cutoff Rd., .1 mi S of US-50.								1800	1750
0127 HRLY 00	Truckee Ln, W of US-95A Spur in Fernley.								820	700